

- LEGEND**
- 5/8" CAPPED REBAR SET
 - IRON PIN FOUND
 - ⊠ MONUMENT BOX FOUND

TOTAL AREA PHASE 19
0.5068 AC.

CURVE DATA

CURVE	RADIUS	LENGTH	TANGENT	CHORD	BEARING	DELTA
C1	25.00'	39.27'	25.00'	35.36'	N48°54'17"E	90°00'00"
C2	89.00'	97.60'	54.36'	92.78'	S35°19'14"W	62°49'55"
C3	24.09'	28.52'	16.20'	26.88'	N52°10'47"W	67°49'53"
C4	111.00'	41.42'	20.95'	41.18'	S56°02'47"W	21°22'49"
C5	289.00'	92.98'	46.90'	92.58'	N57°31'10"E	18°26'05"
C6	289.00'	62.80'	31.52'	62.67'	N29°00'29"E	12°26'59"
C7	111.00'	61.91'	31.78'	61.11'	S38°45'42"W	31°57'26"
C8	89.00'	106.91'	60.97'	100.60'	N57°11'42"E	68°49'27"
C9	311.00'	48.48'	24.29'	48.43'	N35°46'40"E	8°55'51"
C10	311.00'	89.98'	45.31'	89.67'	N58°26'52"E	16°34'40"
C11	311.00'	47.79'	23.94'	47.74'	N54°33'40"E	8°48'16"
C12	311.00'	42.19'	21.13'	42.16'	N62°51'00"E	7°46'24"

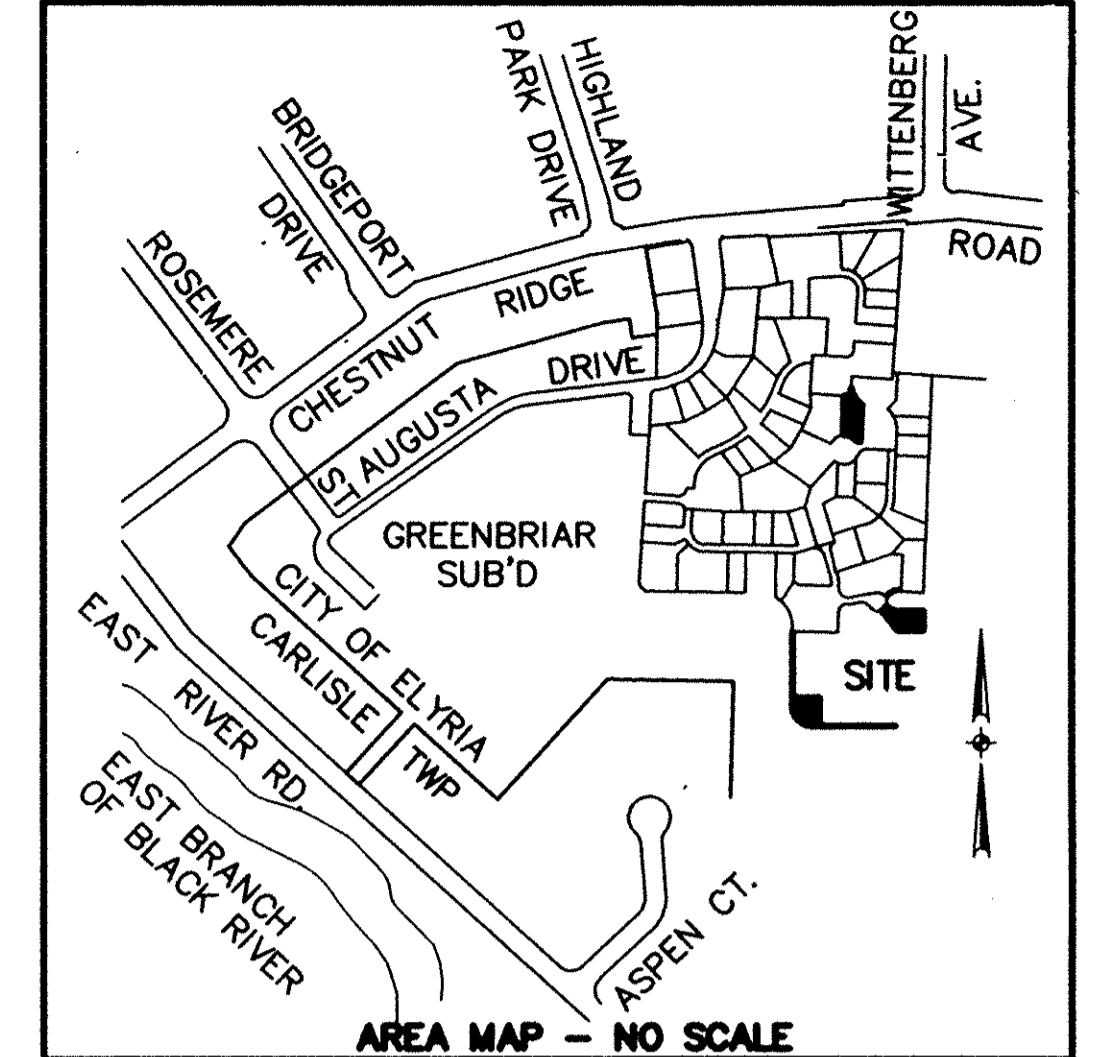

CONTINUED ON SHEET 3

- SHEET INDEX**
- | SHEET NO. | DESCRIPTION |
|-----------|------------------------------|
| 1 | SURVEY MAP & MISC. |
| 2 | SURVEY MAP & MISC. CONTINUED |
| 3 | CURVE DATA & OWNERSHIP TABLE |
| 4 | FLOOR & FOUNDATION PLANS |
| 5 | ELEVATION VIEWS |

OCT 17 2003
 RECEIVED FOR RECORD
 at 2:20 PM, in RECORD
 VOL. 22, JUDITH M. MEDWICK
 PAGES 52, 53, 54, 55
 LORAIN County Recorder
 308.9m
 Box 1076/LANEA

TRANSFERRED
 IN COMPLIANCE WITH SEC. 319-202
 OHIO REV. CODE
 OCT 17 2003
 MARK R. STEWART
 LORAIN COUNTY AUDITOR

CERTIFICATION
 THIS IS TO CERTIFY THAT THE ATTACHED DRAWINGS CORRECTLY REPRESENT THE BUILDINGS AS CONSTRUCTED AND THAT THERE ARE NO ENCROACHMENTS ON ADJACENT PROPERTIES, EXCEPT AS SHOWN.

Lynn S. Miggins
 LYNN S. MIGGINS
 PROFESSIONAL ENGINEER NO. 46837

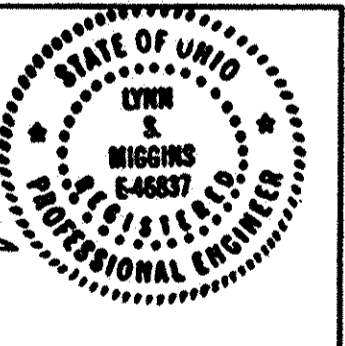

David L. Elwell
 DAVID L. ELWELL
 PROFESSIONAL SURVEYOR NO. 6333

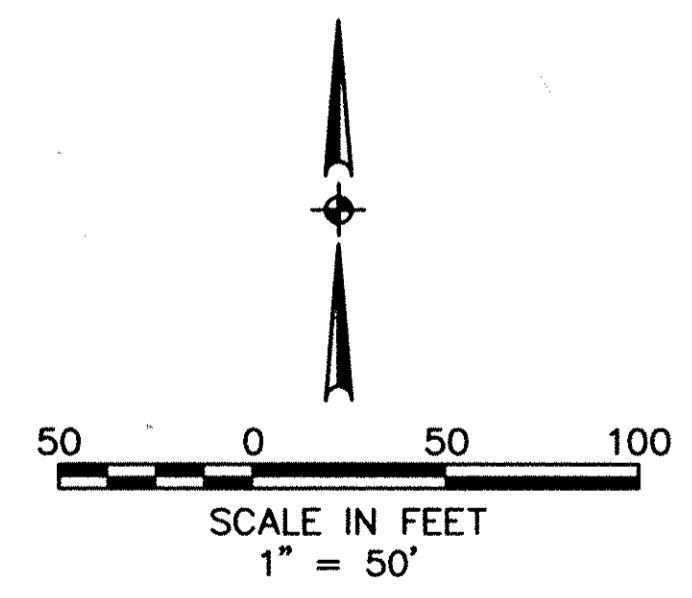
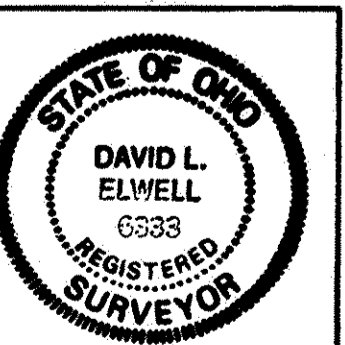

REVISIONS	DATE	DESCRIPTION	BY
	9-15-03	ORIGINAL ISSUE	BAP

KS ASSOCIATES
 KS ASSOCIATES, INC.
 260 Burns Road, Suite 100
 Elyria, Ohio 44035
 Phone (440) 365-4730
 Fax (440) 345-4790
 mailroom@ksassoc.com
 www.ksassoc.com

STONEHEDGE CONDOMINIUMS
PHASE NO. 19
 PART OF CARLSLE TOWNSHIP SECTION NO. 5 & A RESUBDIVISION
 OF STONEHEDGE CONDOMINIUM PHASE NO. 17 REC. P.V. 75 PP. 20-24
 CITY OF ELYRIA COUNTY OF LORAIN STATE OF OHIO

SHEET
1 OF
5
 JOB NO.
92424-CP19

CURVE DATA

A Δ = 38'07"27" R = 25.00' T = 8.54' L = 16.63' C = 16.33' CB = S25'28'22"E
N Δ = 20'15"21" R = 190.00' T = 33.94' L = 67.17' C = 66.82' CB = N72'54'03"E
AA Δ = 51'10"38" R = 87.45' T = 41.88' L = 78.11' C = 78.54' CB = S21'11'35"E
B Δ = 80'47"16" R = 130.00' T = 110.61' L = 183.30' C = 168.49' CB = S42'38'06"W
O Δ = 56'14"17" R = 190.00' T = 101.53' L = 186.49' C = 179.10' CB = N54'54'35"E
BB Δ = 58'56"55" R = 71.00' T = 40.13' L = 73.05' C = 69.87' CB = N25'34'00"W
C Δ = 24'32"58" R = 190.00' T = 41.34' L = 81.41' C = 80.79' CB = N14'30'57"E
P Δ = 32'18"52" R = 66.00' T = 19.12' L = 37.22' C = 36.73' CB = N77'00'57"W
CC Δ = 33'20"33" R = 87.45' T = 26.19' L = 50.89' C = 50.18' CB = S12'16'32"E
D Δ = 40'05"31" R = 25.00' T = 9.12' L = 17.49' C = 17.14' CB = N13'39'13"E
Q Δ = 26'48"49" R = 66.00' T = 15.73' L = 30.89' C = 30.61' CB = N17'49'23"W
DD Δ = 17'50"05" R = 87.45' T = 13.72' L = 27.22' C = 27.11' CB = S37'51'51"E
E Δ = 53'07"38" R = 25.00' T = 12.50' L = 23.18' C = 22.36' CB = N60'15'48"E
R Δ = 22'39"54" R = 190.00' T = 38.08' L = 75.16' C = 74.67' CB = N38'07'23"E
EE R=44.00' L=61.06' Tan=36.60' Δ=79'30'36" CH=56.28' CB=N75'53'54"E
F Δ = 14'39"14" R = 200.00' T = 25.72' L = 51.15' C = 51.01' CB = N16'05'46"E
S Δ = 13'19"02" R = 190.00' T = 22.18' L = 44.16' C = 44.06' CB = N56'06'51"E
FF R=111.00' L=37.75' Tan=19.06' Δ=19'29'03" CH=37.57' CB=N11'59'35"E
G Δ = 26'29"29" R = 55.00' T = 12.95' L = 25.43' C = 25.20' CB = N76'45'16"W
T Δ = 13'46"24" R = 190.00' T = 22.95' L = 45.67' C = 45.56' CB = N69'39'34"E
GG R=89.00' L=62.53' Tan=32.62' Δ=40'15'29" CH=61.26' CB=S22'22'47"W
H Δ = 8'47"02" R = 111.00' T = 8.53' L = 17.02' C = 17.00' CB = S82'26'06"W
U Δ = 29'37"44" R = 66.00' T = 17.46' L = 34.13' C = 33.75' CB = N46'02'39"W
HH R=311.00' L=42.19' Tan=21.13' Δ=7'46'24" CH=42.16' CB=N62'51'00"E
I Δ = 0'51'42" R = 589.00' T = 4.43' L = 8.86' C = 8.86' CB = N78'28'26"E
V Δ = 90'00"00" R = 25.00' T = 25.00' L = 39.27' C = 35.36' CB = S48'54'17"W
II R=44.00' L=71.36' Tan=46.30' Δ=10'54'51" CH=19.97' CB=N53'52'53"W
J Δ = 2'48'19" R = 589.00' T = 14.42' L = 28.84' C = 28.84' CB = N85'25'27"E
W Δ = 111'07"22" R = 44.00' T = 64.17' L = 85.34' C = 72.58' CB = S76'02'37"W
JJ R=89.00' L=19.30' Tan=9.69' Δ=12'25'38" CH=19.27' CB=N84'46'11"E
K Δ = 97'04"40" R = 44.00' T = 49.80' L = 74.55' C = 65.95' CB = S44'38'03"E
X Δ = 110'53"45" R = 44.00' T = 63.90' L = 74.55' C = 65.95' CB = N79'51'52"E
KK R=111.00' L=35.01' Tan=17.65' Δ=18'04'23" CH=34.87' CB=S81'56'49"W
L Δ = 88'45'25" R = 66.00' T = 64.58' L = 102.24' C = 92.32' CB = N48'47'41"W
Y Δ = 43'03"41" R = 25.00' T = 9.86' L = 18.79' C = 18.35' CB = S66'13'06"E
LL R=66.00' L=73.16' Tan=40.85' Δ=6'3'30"38" CH=69.47' CB=N57'15'41"W
M Δ = 08'19"15" R = 66.00' T = 4.80' L = 9.59' C = 9.58' CB = N00'15'21"W
Z Δ = 71'46"07" R = 25.00' T = 18.09' L = 31.31' C = 29.31' CB = S56'22'00"W

MM R=44.00' L=12.25' Tan=6.16' Δ=15'57'06" CH=12.21' CB=S56'22'15"E
XX R=111.00' L=35.01' Tan=17.65' Δ=18'04'23" CH=34.87' CB=S08'03'11"E
II R=89.00' L=28.07' Tan=14.15' Δ=18'04'23" CH=27.96' CB=N08'03'11"W
NN R=44.00' L=12.03' Tan=6.05' Δ=15'39'39" CH=11.99' CB=N28'18'46"E
YY R=25.00' L=39.27' Tan=25.00' Δ=90'00'00" CH=35.36' CB=S44'01'00"E
JJ R=25.00' L=39.27' Tan=25.00' Δ=90'00'00" CH=35.36' CB=N62'05'23"W
OO R=66.00' L=19.04' Tan=9.59' Δ=16'31'41" CH=18.97' CB=S33'46'12"E
ZZ R=25.00' L=4.88' Tan=2.45' Δ=11'11'22" CH=4.87' CB=N85'23'19"E
PP R=89.00' L=47.22' Tan=24.18' Δ=30'24'05" CH=46.67' CB=S57'42'35"W
1A R=27.50' L=27.57' Tan=15.07' Δ=57'27'05" CH=26.43' CB=S71'28'49"E
1L R=44.00' L=41.04' Tan=22.15' Δ=53'26'07" CH=39.56' CB=N39'12'19"W
QQ R=66.00' L=54.12' Tan=28.69' Δ=46'58'57" CH=52.62' CB=S65'31'31"E
1B R=30.00' L=23.08' Tan=12.14' Δ=44'04'16" CH=22.51' CB=N70'12'06"E
1M R=45.00' L=69.78' Tan=44.11' Δ=88'51'05" CH=63.00' CB=N43'26'32"W
RR R=211.00' L=40.81' Tan=20.47' Δ=11'04'56" CH=15.31' CB=S69'44'13"W
1C R=20.00' L=15.71' Tan=8.28' Δ=45'00'00" CH=15.31' CB=S69'44'13"W
SS R=111.00' L=8.59' Tan=4.30' Δ=4'26'03" CH=8.59' CB=N88'45'59"E
1D R=27.50' L=82.44' Tan=381.87' Δ=171'45'43" CH=54.86' CB=S64'26'30"W
10 R=27.50' L=21.84' Tan=11.54' Δ=45'30'46" CH=21.27' CB=N01'19'02"E
TT R=105.00' L=20.00' Tan=10.03' Δ=10'54'51" CH=19.97' CB=N53'52'53"W
1E R=25.00' L=30.77' Tan=17.68' Δ=70'31'44" CH=28.87' CB=N64'56'30"W
UU R=105.00' L=54.39' Tan=27.82' Δ=29'40'41" CH=53.78' CB=N74'10'39"W
1F R=45.00' L=8.79' Tan=4.41' Δ=11'11'22" CH=8.77' CB=S85'23'19"W
VV R=111.00' L=26.42' Tan=13.27' Δ=13'38'20" CH=26.36' CB=N79'43'47"E
1G R=25.00' L=39.27' Tan=25.00' Δ=90'00'00" CH=35.36' CB=S45'59'00"W
WW R=25.00' L=34.59' Tan=20.71' Δ=79'15'49" CH=31.89' CB=N22'32'32"E
1H R=105.00' L=90.54' Tan=48.30' Δ=49'24'27" CH=87.76' CB=N23'43'14"W

OWNERSHIP PERCENTAGES

Table with columns: UNIT NO., SQ. FT., ELEV. F.F., % OWNERSHIP. Rows 1-101 showing ownership percentages for various units, totaling 100.00%.

Table with columns: DATE, DESCRIPTION, BY. Includes a REVISIONS column and a BAP column.

KS ASSOCIATES logo and contact information: 260 Burns Road, Suite 100, Elyria, Ohio 44035. Phone (440) 365-4730. Fax (440) 365-4790. Email mailroom@ksassoc.com. Website www.ksassoc.com.

STONEHEDGE CONDOMINIUMS PHASE NO. 19. PART OF CARLISLE TOWNSHIP SECTION NO. 5 & A RESUBDIVISION OF STONEHEDGE CONDOMINIUM PHASE NO. 17 REC. P.V.75 PP20-24 CITY OF ELYRIA COUNTY OF LORAIN STATE OF OHIO.

SHEET 3 OF 5. JOB NO. 92424-CP19.

