

- LEGEND**
- 5/8" CAPPED REBAR SET
 - ⊙ IRON PIN FOUND
 - ⊞ MONUMENT BOX FOUND

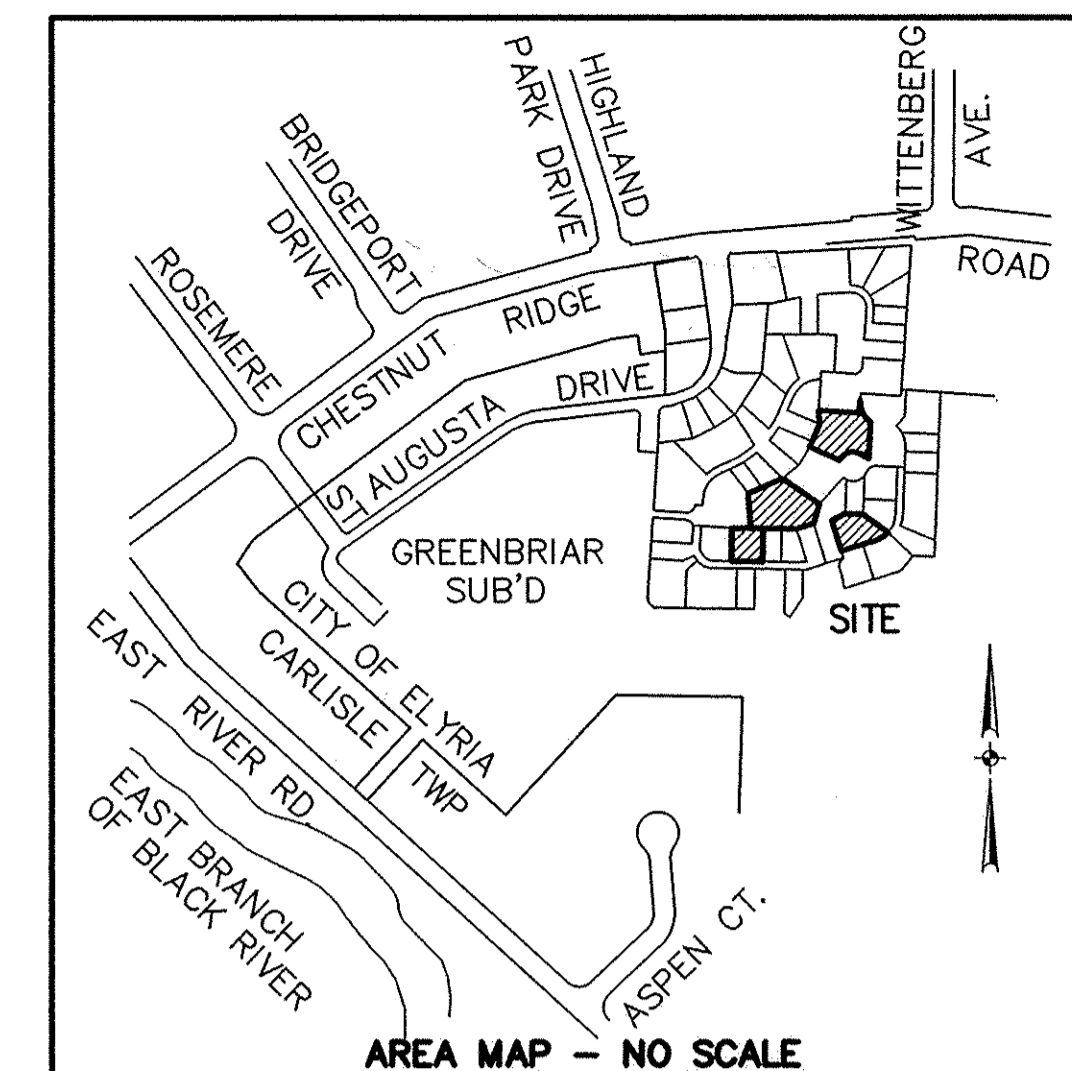

TOTAL AREA PHASE 17
1.4671 AC.

CURVE DATA						
CURVE	RADIUS	LENGTH	TANGENT	CHORD	BEARING	DELTA
C1	25.00'	39.27'	25.00'	35.36'	N48°54'17"E	90°00'00"
C2	89.00'	97.60'	54.36'	92.78'	S35°19'14"W	62°49'55"
C3	24.09'	28.52'	16.20'	26.88'	N52°10'47"W	67°49'53"
C4	111.00'	41.42'	20.95'	41.18'	S56°02'47"W	21°22'49"
C5	289.00'	92.98'	46.90'	92.58'	N57°31'10"E	18°26'05"
C6	289.00'	62.80'	31.52'	62.67'	N29°00'29"E	12°26'59"
C7	111.00'	61.91'	31.78'	61.11'	S38°45'42"W	31°57'26"
C8	89.00'	106.91'	60.97'	100.60'	N57°11'42"E	68°49'27"
C9	311.00'	48.48'	24.29'	48.43'	S35°46'40"E	8°55'51"
C10	311.00'	89.98'	45.31'	89.67'	N58°26'52"E	16°34'40"
C11	311.00'	47.79'	23.94'	47.74'	N54°33'40"E	8°48'16"
C12	311.00'	42.19'	21.13'	42.16'	N62°51'00"E	7°46'24"

CONTINUED ON SHEET 3

SHEET INDEX

SHEET NO.	DESCRIPTION
1	SURVEY MAP & MISC.
2	SURVEY MAP & MISC. CONTINUED
3	CURVE DATA & OWNERSHIP TABLE
4	FLOOR & FOUNDATION PLANS
5	ELEVATION VIEWS

TRANSFERRED
IN COMPLIANCE WITH SEC. 319-202
OHIO REV. CODE
FEB 14 2003
MARK R. STEWART
ORAIN COUNTY AUDITOR

CERTIFICATION
THIS IS TO CERTIFY THAT THE ATTACHED DRAWINGS CORRECTLY REPRESENT THE BUILDINGS AS CONSTRUCTED AND THAT THERE ARE NO ENCROACHMENTS ON ADJACENT PROPERTIES, EXCEPT AS SHOWN.

Lynn S. Miggins
LYNN S. MIGGINS
PROFESSIONAL ENGINEER NO. 46837

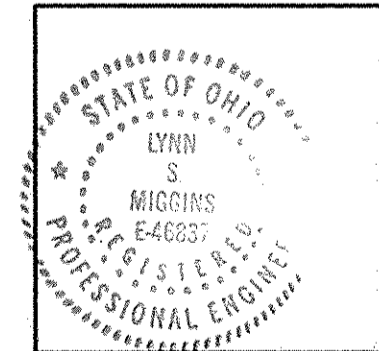

David L. Elwell
DAVID L. ELWELL
PROFESSIONAL SURVEYOR NO. 6333

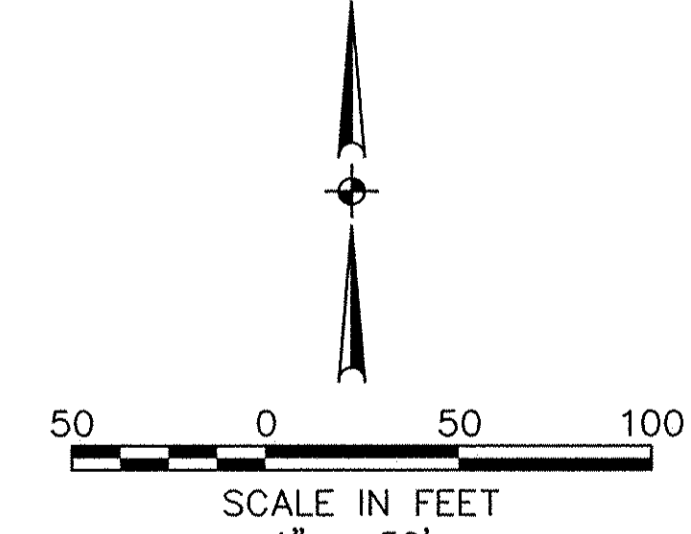
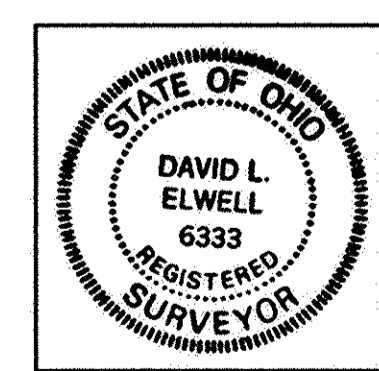

FEB 14 2003
RECEIVED FOR RECORD
at 1:27 clock P.M. in Plat Record
VOL. 75 MARY ANN JAMISON
PAGE 5 Lorain County Recorder
20, 21, 22, 23, 24, 100-2
By Lete/Kanaa
2/16 N K/L/DJR

REVISIONS	DATE	DESCRIPTION	BY
	12/31/02	ORIGINAL ISSUE	BAP

KS ASSOCIATES, INC.
260 Burns Road, Suite 100
P.O. Box 569
Elyria, Ohio 44036
Phone (440) 305-4730
Fax (440) 305-4790
mailroom@ksassoc.com
www.ksassoc.com

**STONEHEDGE CONDOMINIUMS
PHASE NO. 17**

PART OF CARLISLE TOWNSHIP SECTION NO. 5
CITY OF ELYRIA COUNTY OF LORAIN STATE OF OHIO

SHEET 1 OF 5
JOB NO. 92424-CP17

