

LEAR INDUSTRIAL PARK SUBDIVISION NO.2 AS REVISED

PART OF ORIGINAL AVON TOWNSHIP SECTION NO. 21 NOW IN THE CITY OF AVON - COUNTY OF LORAIN - STATE OF OHIO
PREVIOUS RECORDING VOLUME 61, PAGE 70 & 71 L.C.P.R.

EDWARD J. SCHOBER & SOPHIE J. SCHOBER
D.V. 1352, PG. 838

AREA TABULATION

PLATTED SUBLOTS - 25.6690 Acres
BLOCK C - 1.4681 Acres
AREA IN R/W - 2.7630 Acres
TOTAL AREA - 29.8910 Acres
27.1371 A.

LOT REQUIREMENTS

FRONT SETBACK - 60'
SIDEYARD - 20'
REARYARD - 20'
MINIMUM LOT SIZE - 1.0 ACRE

CHESTER ROAD 60'

LEAR INDUSTRIAL PARK VOL. 59, PG. 13

$\Delta = 10'00''00''$
 $R = 3000.00'$
 $T = 262.47'$
 $L = 523.60'$
 $C = 522.93'$
 $N04'35''00''W$

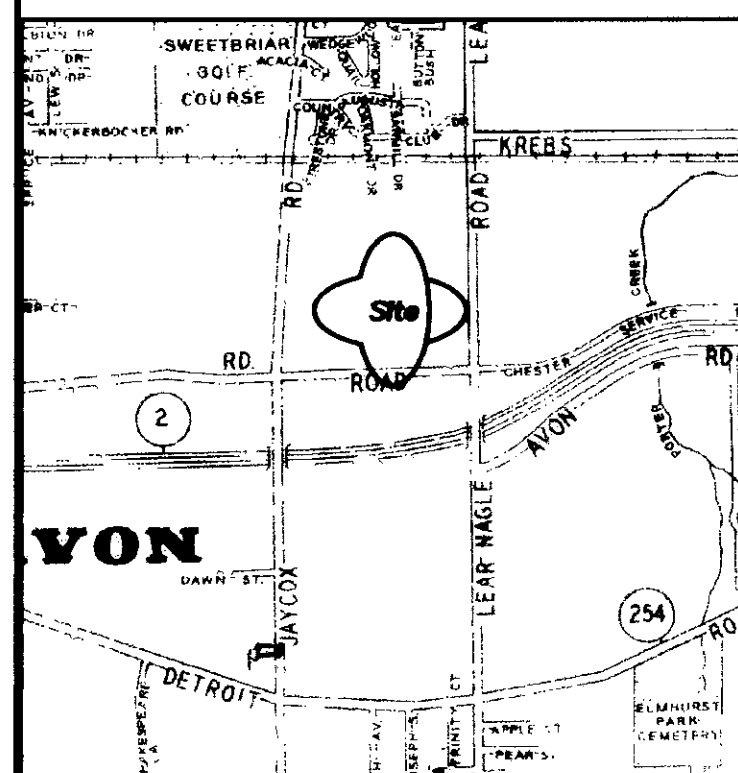

Vicinity Map
Not To Scale!

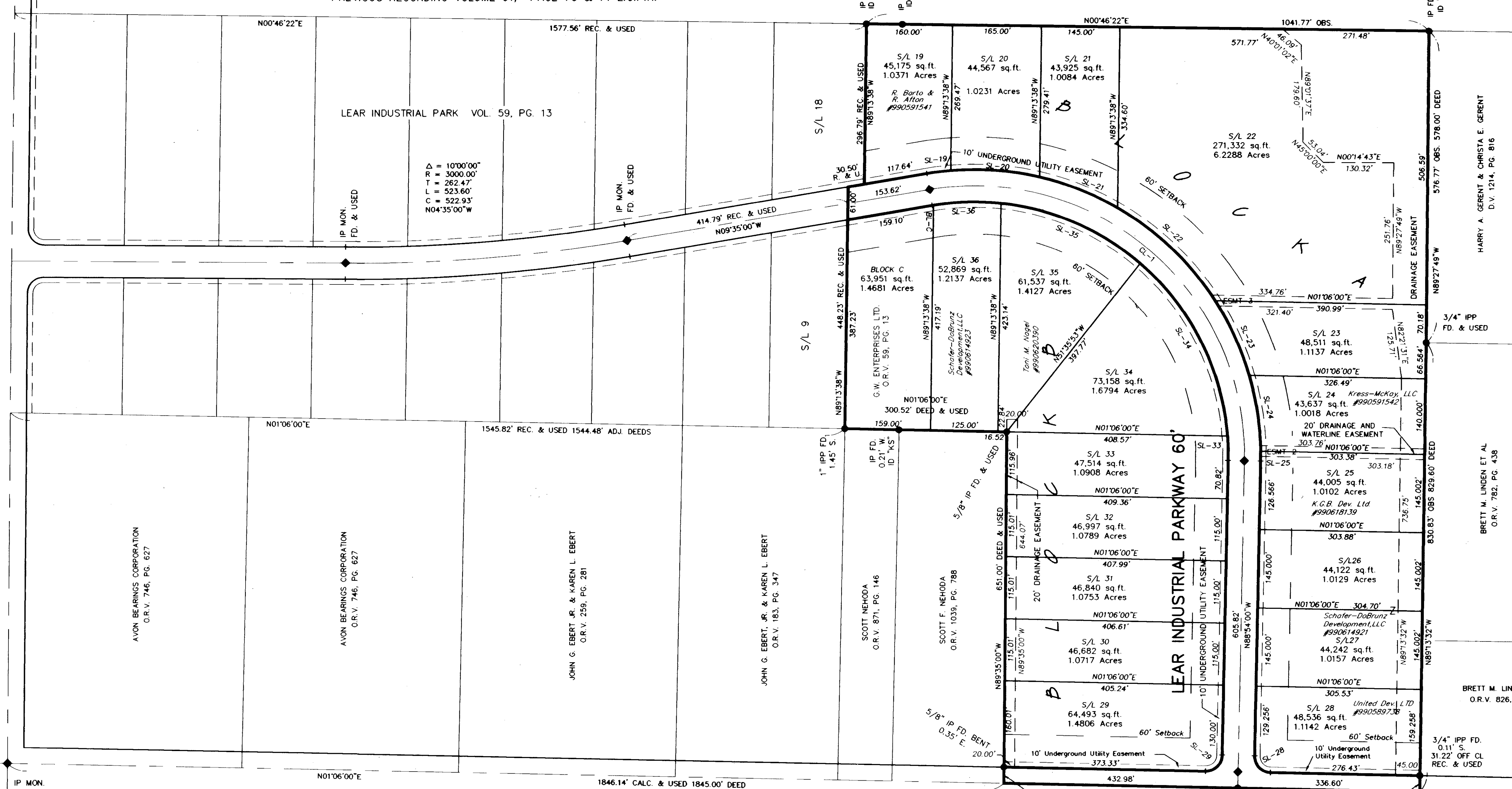

SURVEYORS CERTIFICATE

THIS IS TO CERTIFY THAT AT THE REQUEST OF MARK R. STEWART, AUDITOR OF LORAIN COUNTY AND PURSUANT TO REVISED SECTION 711 OF THE OHIO REVISED CODE, WE HAVE PREPARED THE ABOVE PLAT OF LEAR INDUSTRIAL PARK SUBDIVISION NO.2 AS REVISED, SITUATED IN ORIGINAL AVON TOWNSHIP SECTION NO. 21, CITY OF AVON COUNTY OF LORAIN AND STATE OF OHIO. THE PLAT SHOWN HEREON WAS COMPILED FROM THE ORIGINAL PLAT OF LEAR INDUSTRIAL PARK SUBDIVISION NO.2 RECORDED IN VOLUME 61, PAGE 70 & 71 OF LORAIN COUNTY PLAT RECORDS.

THE PLAT AS SHOWN ABOVE IS A SUBDIVISION OF BLOCKS A, B & C IN SAID RECORDED LEAR INDUSTRIAL PARK SUBDIVISION NO.2, NOW BEING SUBLOTS 20 THROUGH 23 & 29 THROUGH 34 INCLUSIVE. SUBLOTS FILED SEPARATELY 19, 24 THROUGH 28, 35 AND 36 AS SHOWN.

THIS TO CERTIFY THAT SAID BLOCKS A & B, ARE TO BE DELETED BY THE TRANSFER AND RECORDING OF THIS REVISED PLAT.

Richard A. Thompson Jr. 7-26-99
BY RICHARD A. THOMPSON JR. P.S. # 7388

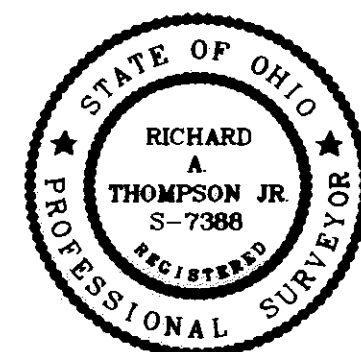

COUNTY AUDITORS CERTIFICATE

COUNTY OF LORAIN STATE OF OHIO S.S.) I, MARK R. STEWART, THE DULY ELECTED AND QUALIFIED COUNTY AUDITOR OF SAID COUNTY AND STATE, DO HEREBY CERTIFY THAT I HAVE CAUSED TO BE MADE, THIS FOREGOING PLAT OF ORIGINAL AVON TOWNSHIP SECTION NO. 21, CITY OF AVON, COUNTY OF LORAIN AND STATE OF OHIO IN ACCORDANCE WITH THE PROVISIONS OF REVISED SECTION 711 OF THE OHIO REVISED CODE. SAID PLAT TO BE KNOWN AS AND DESIGNATED AS "LEAR INDUSTRIAL PARK SUBDIVISION NO.2 AS REVISED". THIS ACTION HAVING BECOME NECESSARY TO ELIMINATE THE NECESSITY TO THE FILING OF THE SPLITS OF SAID BLOCKS A & B FOR INDIVIDUAL LAND OWNERS.

DATE 8-5-99
MARK R. STEWART
AUDITOR OF LORAIN COUNTY

LEAR - NAGLE ROAD 60'

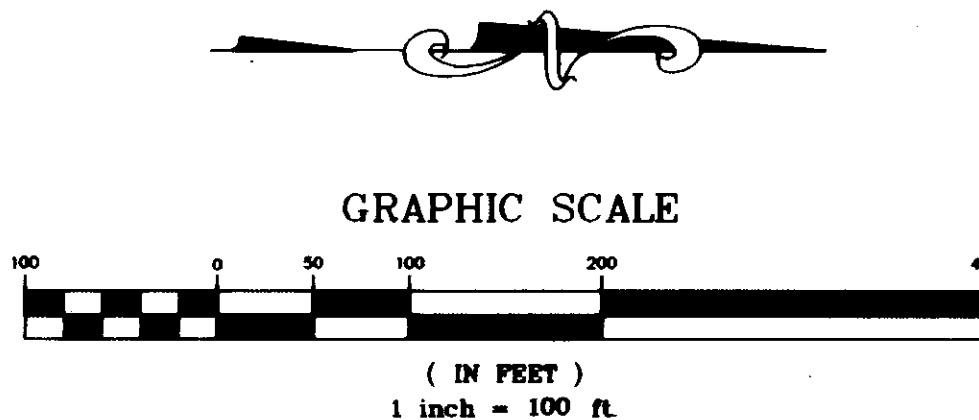

CURVE	RADIUS	LENGTH	TANGENT	CHORD	BEARING	DELTA
BL-C	470.00'	2.53'	1.26'	2.53'	N09'25'45"W	00'18'29"
CL-1	500.00'	878.63'	603.14'	769.86'	N40'45'30"E	100'41'00"
ESMT-2	530.00'	20.01'	10.01'	20.01'	N89'06'23"E	02'09'49"
ESMT-3	530.00'	24.08'	12.04'	24.08'	N57'14'49"E	02'36'13"
SL-19	530.00'	44.72'	22.37'	44.70'	N07'09'58"W	04'50'03"
SL-20	530.00'	165.98'	83.67'	165.30'	N04'13'21"E	17'56'55"
SL-21	530.00'	155.71'	78.42'	155.15'	N21'36'37"E	16'49'58"
SL-22	530.00'	251.89'	128.37'	249.52'	N43'38'30"E	27'13'49"
SL-23	530.00'	152.17'	76.61'	151.64'	N65'28'54"E	16'27'00"
SL-24	530.00'	142.45'	71.66'	142.03'	N81'24'24"E	15'24'00"
SL-25	530.00'	18.44'	9.22'	18.44'	N89'53'48"W	01'59'36"
SL-28	30.00'	47.12'	30.00'	42.43'	N46'06'00"E	90'00'00"
SL-29	30.00'	47.12'	30.00'	42.43'	N43'54'00"W	90'00'00"
SL-33	470.00'	145.20'	22.62'	45.18'	N89'20'47"E	05'30'33"
SL-34	470.00'	367.29'	193.60'	358.01'	N63'12'08"E	44'46'29"
SL-35	470.00'	285.41'	147.26'	281.05'	N23'25'06"E	34'47'36"
SL-36	470.00'	125.48'	63.12'	125.11'	N01'37'36"W	15'17'48"

TRANSFERRED
IN COMPLIANCE WITH SEC. 519-252
OHIO REV. CODE

AUG 5 1999
RECEIVED FOR RECORD
at 3:00 clock P.M. in PLAT RECORD
VOL. 63 MARY ANN JAMISON
PAGE 47 Lorain County Recorder
Box LCTC 1ME 45-28

MARK R. STEWART
LORAIN COUNTY AUDITOR



DRAWN BY:	JRP	DATE:	July 1, 1999
CHECKED BY:	RAT	DRAWING NO.:	PlatR-1
JOB NO.:	SCHAD1-9608	SHEET	1 of 1