

SURVEYOR'S CERTIFICATE

THIS IS TO CERTIFY THAT AT THE REQUEST OF THE OWNER WE HAVE SURVEYED AND PLATTED "HIDDEN MEADOWS SUBDIVISION" AS SHOWN BY THE HEAVY LINE HEREON AND CONTAINING 12.9731 ACRES OF LAND IN ORIGINAL SECTION NUMBER 24 IN THE TOWNSHIP OF CARLISLE, COUNTY OF LORAIN AND STATE OF OHIO. AT ALL POINTS INDICATED THUSBY IRON PIN MONUMENTS WERE SET. ALL OTHER IRON PINS WERE FOUND AS INDICATED. DISTANCES ARE SHOWN IN FEET AND DECIMAL PARTS THEREOF. NORTH AS SHOWN IS TO AN ASSUMED MERIDIAN WITH BEARINGS USED TO DESCRIBE ANGLES ONLY. ALL OF WHICH WE CERTIFY TO BE CORRECT.

LAUNDON • SIMON • CAHL & ASSOC. INC.
ENGINEERS SURVEYORS
BY Rodger G. Simon
RODGER G. SIMON
REGISTERED SURVEYOR
OHIO NO. 5101

ACREAGE BREAKDOWN

ACRES IN LOTS	10.4981
ACRES IN STREET	2.4750
TOTAL ACREAGE	12.9731

ALL CENTERLINE MONUMENTATION SHALL BE SET PER LORAIN COUNTY ENGINEER'S DEPT. STANDARDS AFTER STREET CONSTRUCTION

OWNER'S CERTIFICATE

SITUATED IN THE TOWNSHIP OF CARLISLE, COUNTY OF LORAIN, STATE OF OHIO AND BEING A PART OF ORIGINAL SECTION NO 24 OF SAID TOWNSHIP CONTAINING 12.9731 ACRES OF LAND, AND BEING THE SAME TRACT OF LAND CONVEYED TO C & S LAND DEVELOPMENT, INC. AND DESCRIBED IN OFFICIAL RECORD VOLUME 1050 P 551 IN THE OFFICE OF THE RECORDER FOR THE COUNTY OF LORAIN, STATE OF OHIO

THE UNDERSIGNED, DOES HEREBY CERTIFY THAT THE PLAT SHOWN HEREON REPRESENTS "HIDDEN MEADOWS SUBDIVISION", A SUBDIVISION OF LOT 1 TO 8, INCLUSIVE, DOES HEREBY ACKNOWLEDGE THIS PLAT OF SAME AND DEDICATES TO PUBLIC USE AS SUCH THE STREETS AS SHOWN HEREON AND NOT HERETOFORE DEDICATED

THE UNDERSIGNED FURTHER AGREES THAT ANY USE OR IMPROVEMENTS MADE ON THIS LAND SHALL BE IN CONFORMITY WITH ALL EXISTING PLATTING, ZONING, HEALTH, OR OTHER LAWFUL RULES AND REGULATIONS INCLUDING THE APPLICABLE OFF-STREET LOADING AND PARKING REQUIREMENTS OF LORAIN COUNTY, OHIO, FOR THE BENEFIT OF THEMSELVES AND ALL OTHER SUBSEQUENT PARTIES TAKING TITLE FROM, UNDER, OR THROUGH THE UNDERSIGNED.

EASEMENTS ARE RESERVED WHERE INDICATED ON THIS PLAT FOR PRIVATE AND PUBLIC UTILITY PURPOSES ABOVE AND BELOW THE SURFACE OF THE GROUND.

IN WITNESS WHEREOF THE UNDERSIGNED HAVE HEREUNTO SET THEIR HANDS THIS 22ND DAY OF MAY 1995.

C & S LAND DEVELOPMENT INC
BY Charles M. Taylor
PRESIDENT - CHARLES M. TAYLOR

BY Susan A. Taylor
SECRETARY - SUSAN A. TAYLOR

Gail A. Palkst
WITNESS

Rodger G. Simon
WITNESS

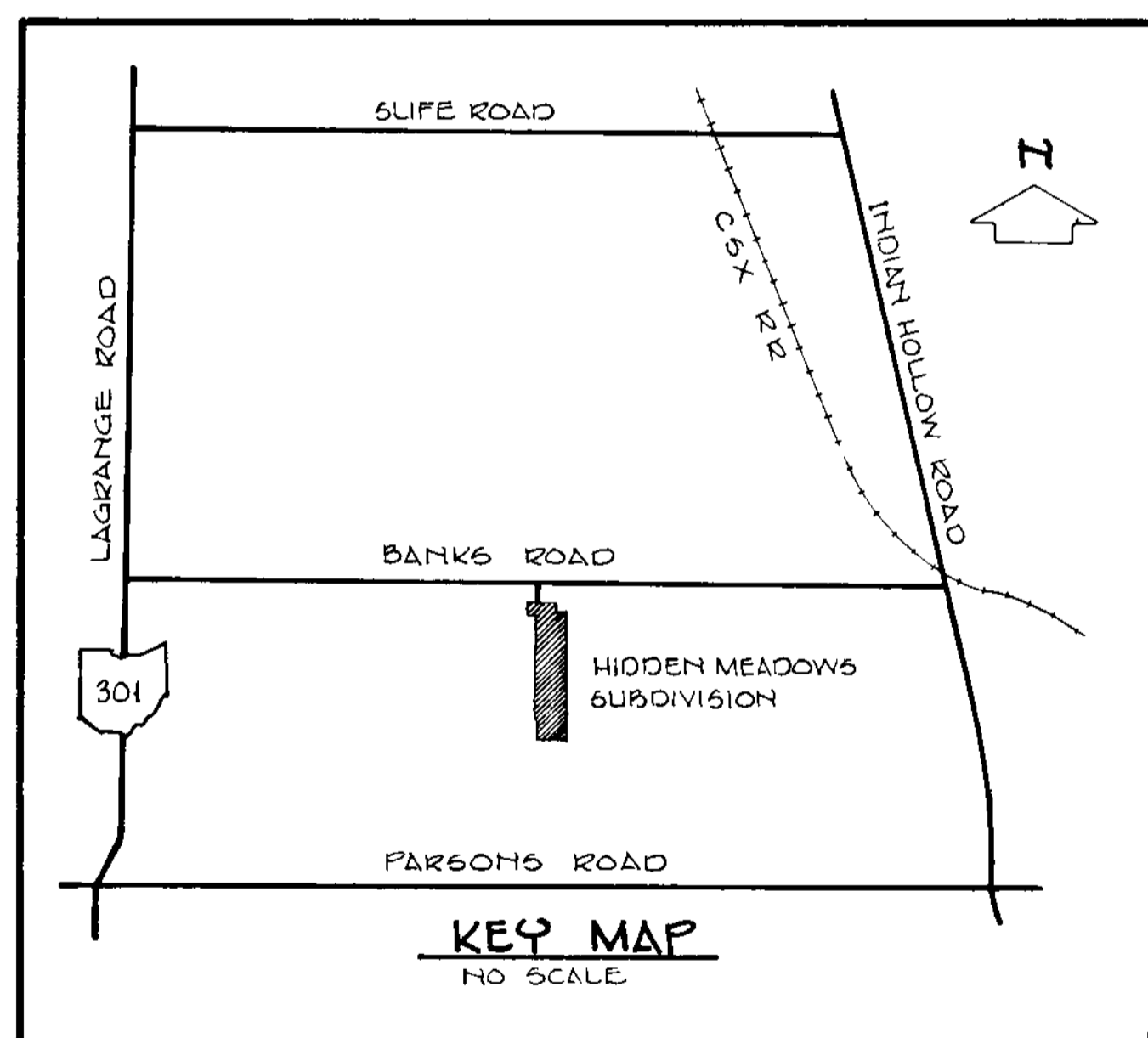

NOTARIAL SEAL

STATE OF OHIO
COUNTY OF LORAIN 66
BEFORE ME, A NOTARY PUBLIC IN AND FOR SAID COUNTY AND STATE DID PERSONALLY APPEAR C & S LAND DEVELOPMENT INC. BY ITS PRESIDENT AND SECRETARY WHO ACKNOWLEDGED THE SIGNING OF THIS PLAT TO BE ITS AND THEIR FREE ACT AND DEED FOR THE USES AND PURPOSES HEREON EXPRESSED.

IN WITNESS WHEREOF I HAVE HEREUNTO SET MY HAND AND OFFICIAL SEAL THIS 22ND DAY OF MAY 1995.

Gail A. Palkst
NOTARY PUBLIC
GAIL A. PALKST
JUN 15, 1994
MY COMMISSION EXPIRES

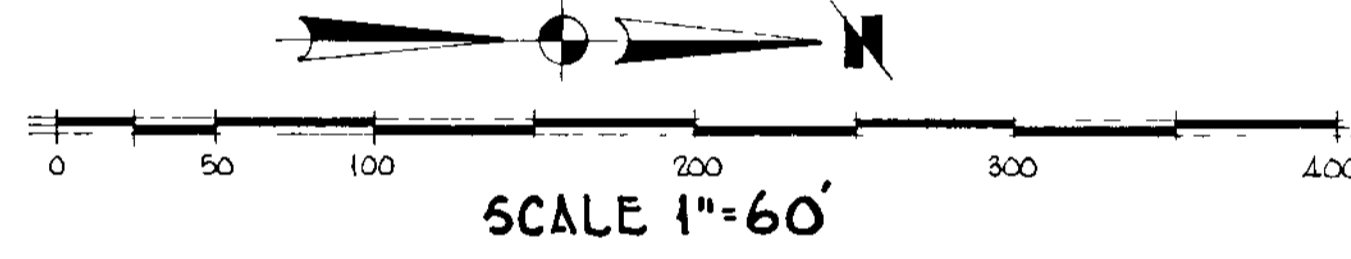

APPROVALS

<u>Kenneth P. Carney</u> LORAIN COUNTY ENGINEER KENNETH P. CARNEY SR	8/2/95 DATE	<u>David Street</u> CHAIRMAN - CARLISLE TWP BO OF TRUSTEES DAVID STREET	2/1/95 DATE
<u>Kenneth P. Carney</u> LORAIN COUNTY SANITARY ENGINEER KENNETH P. CARNEY SR	8/2/95 DATE	<u>Thomas C. Ferensen</u> DIRECTOR - LORAIN CO PLANNING COMMISSION THOMAS C. FERENSEN	3/1/95 DATE
<u>Kenneth G. Pearce</u> LORAIN COUNTY BOARD OF HEALTH KENNETH G. PEARCE	4/3/95 DATE	<u>Gerald A. Innes</u> LORAIN COUNTY PROSECUTOR'S OFFICE GERALD A. INNES	11-11-95 DATE

ACRD
- 090 5.59 A 12.97 A. CORR.
12.96 A.
OUT OF 10-00-024-000-096 7.37 A.
INTD PLAT - 12.97 A.
REMAINDER - NONE 0.00 A.

#21447

APPROVED
LORAIN CO.
MAP DEPT.
DATE 7-14-95
PAGE 10 OF 24-159 F
BY T.M.Han
VOID AFTER 21447

HIDDEN MEADOWS SUBDIVISION

PART OF ORIGINAL SECTION 24 TOWNSHIP OF CARLISLE
COUNTY OF LORAIN STATE OF OHIO

JUNE, 1995

LAUNDON • SIMON • CAHL & ASSOC.
ENGINEERS SURVEYORS
110 MIDDLE AVENUE ELIPRIA, OHIO 44035

AUDITOR _____
RECORDER _____