

082756

082756

COLLEGE GREEN SUBDIVISION NO. 3

PART OF ORIGINAL LOT 7 IN THE BURRELL & DAY TRACT OF ELYRIA TOWNSHIP

CITY OF ELYRIA

WEST OF THE BLACK RIVER

COUNTY OF LORAIN

STATE OF OHIO

SCALE: 1"=50'

FEBRUARY 1979

OWNER'S CERTIFICATE:

This is to certify that the undersigned: LORNE J. ELBERT & LORENE A. ELBERT Owner of land contained within this plat of College Green Subdivision No. 3, having examined the same does hereby accept the same to be correct and dedicate forever, to public use, the streets and easements as shown hereon.

NOTARY PUBLIC:

County of SS
State of Ohio

This is to certify that before me, a Notary Public, in and for said county and state, did personally appear

LORNE J. ELBERT & LORENE A. ELBERT who acknowledged that they did sign the foregoing plat and that it was their own free act and deed. In testimony whereof, I have hereunto set my hand and official seal on this 13th day of March, 1981.

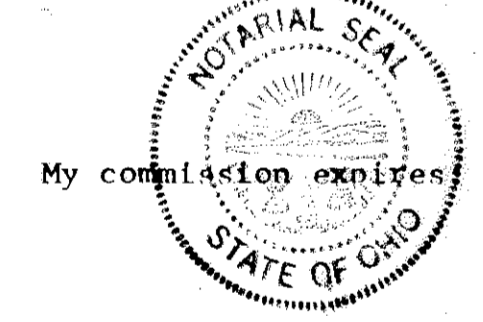

Melissa J. Lisa
Notary Public

My commission expires: 10-4-84

SURVEYOR'S CERTIFICATE:

This is to certify that at the request of the Owner, I have surveyed and platted College Green Subdivision No. 3, as shown hereon, and containing 14.588 acres of land in Original Lot No. 7, in the Burrell and Day Tract of Elyria Township, now in the City of Elyria, County of Lorain, and State of Ohio.

At all points so indicated -o-, iron pin monuments were either found or set. Distances shown are in feet and decimal parts thereof. Bearings shown are assumed and for the purpose of describing angles only. All of which I certify to be correct.

Acresage within Lots = 10.990 AC.
Acresage within Streets = 3.598 AC.
Total Acresage = 14.588 AC.

I hereby certify that the field survey of the boundary shown in this plat of College Green Subdivision No. 3 exceeds one (1) foot in 10,000 precision, as required per Chapter 1117.02, Elyria City Codified Ordinances.

Robert E. Hines
REGISTERED SURVEYOR # 4345

PLANNING COMMISSION:

This is to certify that the Planning Commission of the City of Elyria has approved this plat of College Green Subdivision No. 3 on the 17 day of MARCH, 1981.

James D. Canton
President
Richard G. Thomas
Secretary

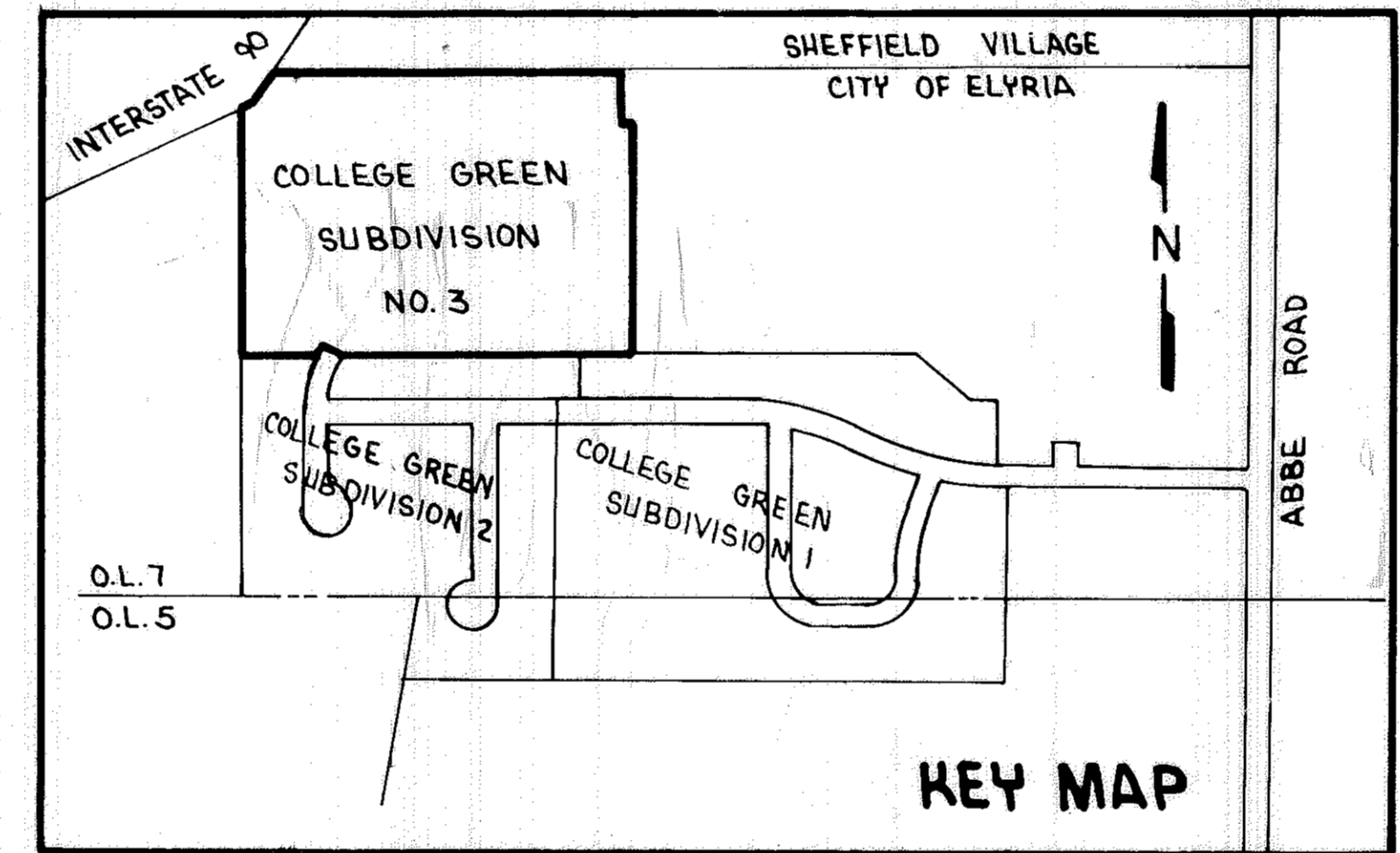

MORTGAGEE'S CERTIFICATE:

This is to certify that the undersigned, representing The Northern Savings and Loan Company, mortgagee of land contained within this plat of College Green Subdivision No. 3, having examined the same does hereby accept the same to be correct and dedicates forever, to public use, the streets and easements as shown hereon.

NOTARY PUBLIC:

County of SS
State of Ohio

This is to certify that before me, a Notary Public, in and for said county and state, did personally appear Eugene Hubbard, President and Neal Hubbard, Secretary

who acknowledged that they did sign the foregoing plat and that it was their own free act and deed, in testimony whereof, I have hereunto set my hand and official seal on this 26th day of March, 1981.

Elba J. Cappley
Notary Public

My commission expires: _____

CITY ENGINEER:

This is to certify that I have examined the plat of College Green Subdivision No. 3 and find the monuments shown set are sufficient to define the streets as shown hereon in compliance with the City of Elyria regulations.

Lorain A. Johnson
Elyria City Engineer

Michael B. King
Mayor

MAYOR:

Approved this 25 day of March, 1981.

MORTGAGEE'S CERTIFICATE:

This is to certify that the undersigned, representing NOT APPLICABLE, mortgagee of land contained within this plat of College Green Subdivision No. 3, having examined the same does hereby accept the same to be correct and dedicates forever, to public use, the streets and easements as shown hereon.

NOTARY PUBLIC:

County of SS
State of Ohio

This is to certify that before me, a Notary Public, in and for said county and state, did personally appear _____

who acknowledged that they did sign the foregoing plat and that it was their own free act and deed, in testimony whereof, I have hereunto set my hand and official seal on this _____ day of _____, 19____.

My commission expires: _____ Notary Public

MORTGAGEE'S CERTIFICATE:

This is to certify that the undersigned, representing NOT APPLICABLE, mortgagee of land contained within this plat of College Green Subdivision No. 3, having examined the same does hereby accept the same to be correct and dedicates forever, to public use, the streets and easements as shown hereon.

NOTARY PUBLIC:

County of SS
State of Ohio

This is to certify that before me, a Notary Public, in and for said county and state, did personally appear _____

who acknowledged that they did sign the foregoing plat and that it was their own free act and deed, in testimony whereof, I have hereunto set my hand and official seal on this _____ day of _____, 19____.

My commission expires: _____ Notary Public

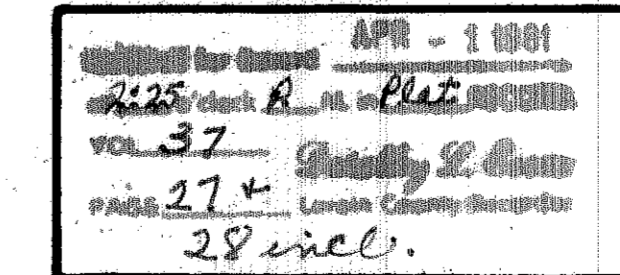

LORAIN COUNTY RECORDER

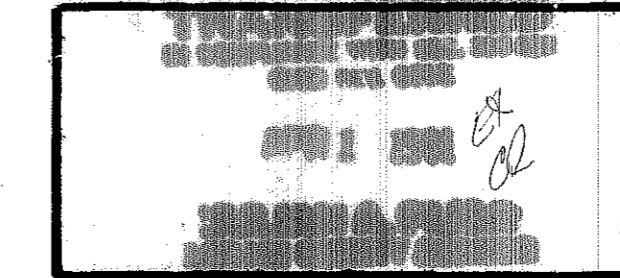

LORAIN COUNTY AUDITOR

34.56
PREP BY:
Lois Co. Sittle
Ken Handley

PREPARED BY:
HLEINOEDER-SCHMIDT & ASSOC.
CONSULTING ENGINEERS & SURVEYORS
424 MIDDLE AVENUE
ELYRIA, OHIO 44035

#082756

N #082756

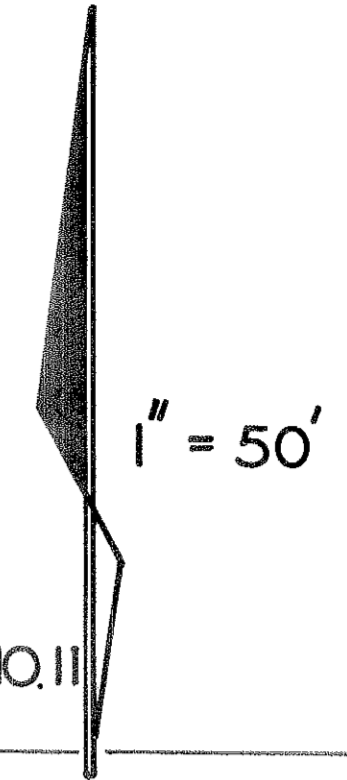

STATE ROUTE 2
INTERSTATE 90

HELEN C. IVAN
DV. 1226 P. 874

HELEN C. IVAN
DV. 1082 P. 838

PAUL & ELIZABETH BUTTI
DV. 398 P. 47

SHEFFIELD VILLAGE
SHEFFIELD TOWNSHIP ORIG. LOT NO. 11

O.L. 6 O.L. 7

ELYRIA CITY - ELYRIA TOWNSHIP ORIG. LOT NO. 7
BURRELL AND DAY TRACT

COLLEGE GREEN SUBDIVISION NO. 3

ELYRIA TOWNSHIP ORIGINAL LOT NO. 7
IN THE BURRELL AND DAY TRACT
CITY OF ELYRIA COUNTY OF LORAIN
STATE OF OHIO

LORNE J. ELBERT
DV. 1189 P. 285

CURVE DATA
COLLEGE GREEN #3

Mark	Radius	Central Angle	Arc	Tangent	Chord	Chord Bearing
1	265.17	00° 29' 52"	2.30	1.15	2.30	N 21° 15' 26" E
2	265.17	21° 10' 04"	97.97	49.55	97.41	S 10° 25' 28" W
3	235.17	21° 39' 56"	88.92	45.00	88.40	N 10° 40' 24" E
4	205.17	6° 00' 35"	21.52	10.77	21.51	S 02° 50' 43" W
5	205.17	15° 39' 23"	56.06	28.21	55.89	S 13° 40' 41" W
6	30.00	89° 06' 45"	46.66	29.54	42.10	N 44° 23' 48" E
7	30.00	89° 53' 15"	47.59	30.47	42.75	S 45° 36' 12" E
8	70.00	89° 06' 45"	108.87	68.92	98.22	N 44° 23' 48" E
9	130.00	17° 44' 09"	40.24	20.28	40.08	N 80° 05' 30" E
10	130.00	25° 16' 17"	57.34	29.14	56.88	N 58° 34' 36" E
11	130.00	25° 16' 17"	57.34	29.14	56.88	N 33° 18' 36" E
12	130.00	20° 50' 02"	47.27	23.90	46.10	N 10° 25' 27" E
13	100.00	89° 06' 45"	155.53	98.46	140.32	N 44° 23' 48" E
14	30.00	90° 00' 00"	47.12	30.00	42.43	S 46° 02' 49" E
15	30.00	90° 00' 00"	47.12	30.00	42.43	N 43° 57' 11" E
16	30.00	90° 00' 00"	47.12	30.00	42.43	N 46° 02' 49" W
17	30.00	90° 00' 00"	47.12	30.00	42.43	S 43° 57' 11" W
18	30.00	90° 00' 00"	47.12	30.00	42.43	S 46° 02' 49" E
19	30.00	90° 00' 00"	47.12	30.00	42.43	S 46° 02' 49" E
20	30.00	89° 56' 56"	47.10	29.97	42.41	N 43° 58' 43" E
21	30.00	90° 03' 04"	47.15	30.03	42.44	N 46° 01' 17" W

COLLEGE GREEN SUBD. NO. 1
VOL. 33 P. 64

COLLEGE GREEN SUBD. NO. 2
VOL. 34 P. 16

TOTAL AREA IN PLAT 14.588 AC.
AREA IN STREETS 3.598 AC.
AREA IN LOTS 10.990 AC.

- 48" x 1" IRON PIPE TO BE SET, FLUSH WITH FINISHED GRADE.
- 48" x 6" DIA. PERMANENT MONUMENT WITH IRON PIN CONCRETE ENCASED, TO BE SET.
- MONUMENT BOXES, TO BE INSTALLED.

NOTE: Owners of lots on this part of College Green Subdivision No. 3 are responsible for the proper maintenance of swales, yard inlets, and storm sewer pipes (12" dia. and under) on or crossing their respective sublots to insure the proper maintenance of the proper drainage pattern throughout the subdivision.

37/28

GREENFIELD ESTATES NO. 3
VOL. 30 P. 40

72

71

70

69

68

72

71

70

69

68

67

66

65

64

63

62

61

60

59

58

57

56

55

54

53

52

51

50

49

48

47

46

45

44

43

42

41

40

39

38

37

36

35

34

33

32

31

30

29

28

27

26

25

24

23

22

21

20

19

18

17

16

15

14

13

12

11

10

9

8

7

6

5

4

3

2

1

0

-1

-2

-3

-4

-5

-6

-7

-8

-9

-10

-11

-12

-13

-14

-15

-16

-17

-18

-19

-20

-21

-22

-23

-24

-25

-26

-27

-28

-29

-30

-31

-32

-33

-34

-35

-36

-37

-38

-39

-40

-41

-42

-43

-44

-45

-46

-47

-48

-49

-50

-51

-52

-53

-54

-55

-56

-57

-58

-59

-60

-61

-62

-63

-64

-65

-66

-67

-68

-69

-70

-71

-72

-73

-74

-75

-76

-77

-78

-79

-80

-81

-82

-83

-84

-85

-86

-87

-88

-89

-90

-91

-92

-93

-94

-95

-96

-97

-98

-99

-100

-101

-102

-103

-104

-105

-106

-107

-108

-109

-110

-111

-112

-113

-114

-115

-116

-117

-118

-119

-120

-121

-122

-123

-124

-125

-126

-127

-128

-129

-130

-131

-132

-133

-134

-135

-136

-137

-138

-139

-140

-141

-142

-143

-144

-145

-146

-147

-148

-149

-150

-151

-152

-153

-154

-155

-156

-157

-158

-159

-160

-161

-162

-163

-164

-165

-166

-167

-168

-169

-170

-171

-172

-173

-174

-175

-176

-177

-178

-179

-180

-181

-182

-183

-184

-185

-186

-187

-188

-189