

TRANSFERRED  
IN COMPLIANCE WITH SEC. 19-202  
OHIO REV. CODE  
OCT 3 1979  
JULIAN A. PIOR  
LORAIN COUNTY AUDITOR

43350

957108  
957108  
43350

# THE RE-SUBDIVISION OF

THE FULLER NELSON SUBDIVISION  
P.V. 2 PG. 18

AND

THE LINDALE ALLOTMENT  
P.V. 6 PG. 42

PART OF ORIGINAL CARLISLE TOWNSHIP LOT NO. 4

CITY OF ELYRIA

COUNTY OF LORAIN

STATE OF OHIO

PREPARED BY: KLEINOEDER-SCHMIDT & ASSOC.  
ENGINEERS AND SURVEYORS  
REVISED: JUNE 19, 1978  
(SEE NOTE ON SHEET 2)

### PLANNING COMMISSION

THIS IS TO CERTIFY THAT I HAVE EXAMINED THE FOREGOING PLAT OF THE RE-SUBDIVISION OF THE FULLER NELSON SUBDIVISION AND THE LINDALE ALLOTMENT AND THE SAME IS HEREBY APPROVED BY THE PLANNING COMMISSION OF THE CITY OF ELYRIA ON THIS 17<sup>th</sup> DAY OF June 1976

James D. Anton PRESIDENT  
Jacqueline S. Charles SECRETARY  
REVISED PLAT APPROVED.  
DATE: 7/26/78

James D. Anton PRESIDENT  
Jacqueline S. Charles SECRETARY

### SURVEYOR'S CERTIFICATE

THIS IS TO CERTIFY THAT THE FOREGOING PLAT OF THE RESUBDIVISION OF THE FULLER NELSON SUBDIVISION AND THE LINDALE ALLOTMENT WAS MADE AT THE REQUEST OF THE OWNER, THE CITY OF ELYRIA, EMBRACING 48.721 ACRES OF LAND, IN ORIGINAL LOT NO. 4 OF CARLISLE TOWNSHIP, LORAIN COUNTY, OHIO. ALL BEARINGS ARE ASSUMED AND ARE FOR THE PURPOSE OF DESCRIBING ANGLES ONLY, ALL OF WHICH I CERTIFY TO BE CORRECT.

ACREAGE IN LOTS 35.323  
ACREAGE IN R/W 13.398  
TOTAL ACREAGE 48.721

Robert E. Kleinoeder  
REGISTERED SURVEYOR  
REVISED: JUNE 19, 1978

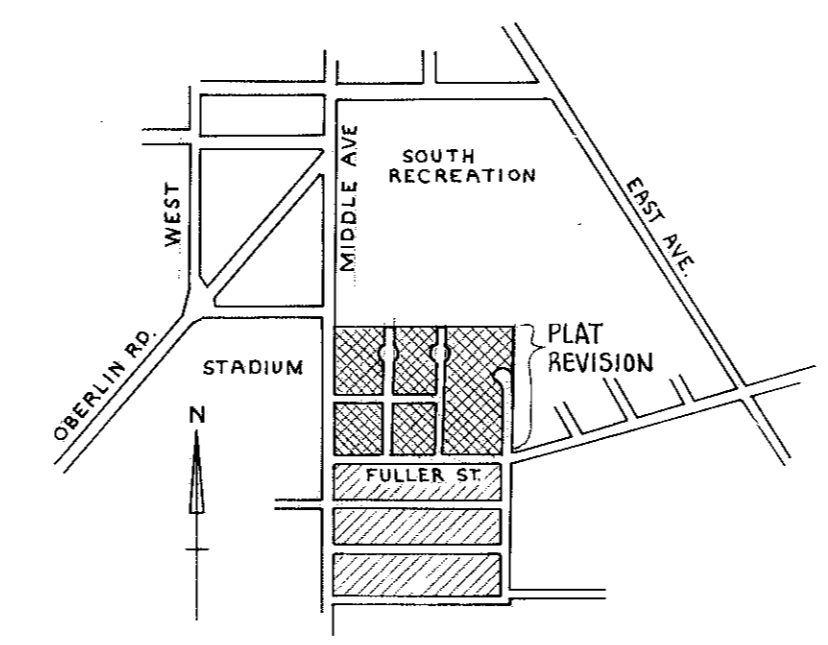

KEY MAP  
NO SCALE

### OWNERS CERTIFICATE

THIS IS TO CERTIFY THAT THE CITY OF ELYRIA, AS REPRESENTED BY THE UNDERSIGNED, HAS EXAMINED THE FOREGOING PLAT OF THE RE-SUBDIVISION OF THE FULLER NELSON SUBDIVISION AND THE LINDALE ALLOTMENT, AND DOES HEREBY ACCEPT THE SAME TO BE CORRECT AND RE-DEDICATES FOREVER TO PUBLIC USE MIDDLE AVE., LINWOOD CT., SCOTT CT., EDWARD CT., HAYES ST., EDWARD AVE., NELSON ST., FULLER ST., STATE ST., WAYNE ST., WOOD ST. AND PARKS AS SHOWN HEREON. AC. WITHIN R/W = 13.398 AC.

Marguerite E. Bowman  
MAYOR

REVISED PLAT APPROVED.  
DATE: 7-26-78  
Marguerite E. Bowman  
MAYOR

COUNTY OF LORAIN } S.S.  
STATE OF OHIO }  
THIS IS TO CERTIFY THAT BEFORE ME, A NOTARY PUBLIC IN AND FOR SAID COUNTY AND STATE DID PERSONALLY APPEAR MARGUERITE E. BOWMAN REPRESENTING THE CITY OF ELYRIA WHO ACKNOWLEDGED THAT SHE DID SIGN THE FOREGOING PLAT AND THAT IT WAS HER OWN FREE ACT AND DEED IN TESTIMONY WHEREOF I HAVE HEREIN TO SET MY HAND AND OFFICIAL SEAL ON THIS 26<sup>th</sup> DAY OF July 1978.

Robert J. Kuntz  
NOTARY PUBLIC

MY COMMISSION EXPIRES September 1981

COUNTY OF LORAIN } S.S.  
STATE OF OHIO }  
THIS IS TO CERTIFY THAT BEFORE ME, A NOTARY PUBLIC IN AND FOR SAID COUNTY AND STATE DID PERSONALLY APPEAR THE CITY OF ELYRIA AS REPRESENTED BY THE ABOVE SIGNED OFFICIAL WHO ACKNOWLEDGED THE SIGNING OF THIS PLAT TO BE OF HIS OWN FREE ACT AND DEED. IN TESTIMONY WHEREOF I HAVE HEREIN TO SET MY HAND AND OFFICIAL SEAL THIS 8<sup>th</sup> DAY OF October 1976.

Vera T. Kunn  
NOTARY PUBLIC

MY COMMISSION EXPIRES \_\_\_\_\_

Received for Record  
OCT-3 1979  
at 3:44 clock P.M. in PLAT RECORD  
VOL. 435  
PAGE 47  
Dorothy L. Esser  
Lorain County Recorder

Received for Record  
AUG-4 1977  
at 1:48 clock P.M. in PLAT RECORD  
VOL. 32  
PAGE 51-52  
Dorothy L. Esser  
Lorain County Recorder

TRANSFERRED  
IN COMPLIANCE WITH SEC. 19-202  
OHIO REV. CODE  
AUG 4 1977  
JULIAN A. PIOR  
LORAIN CO.

Re-Record  
Bot. Lorain County Title  
(Ken Handley) SK  
Re-Rec'd  
\$36.06  
3 M/E.

TRANSFERRED  
IN COMPLIANCE WITH SEC. 319.02  
OHIO REV. CODE  
OCT 3 1978  
JULIAN A. PLOER  
LORAIN COUNTY AUDITOR

# 43350

957108  
43350



SCALE: 1"=100'



CURVE NO.	RADIUS	Δ	CH.	TAN	ARC	C.B.
1.	60.00	59°59'50"	60.00	34.64	62.83	N-29°27'41"-W
2.	60.00	79°14'29"	76.52	49.61	82.98	S-80°55'01"-W
3.	60.00	77°10'12"	74.84	47.87	80.81	S-2°42'41"-W
4.	60.00	23°35'29"	24.53	12.53	24.70	N-47°40'10"-W
5.	60.00	60°00'00"	60.00	34.64	62.83	N-29°27'53"-W
6.	39.34	49°34'29"	32.99	18.17	34.03	N-25°00'05"-E
7.	60.00	79°49'06"	72.07	45.06	71.30	N-12°52'51"-E
8.	60.00	41°03'07"	42.08	22.46	42.99	N-44°33'10"-W
9.	60.00	76°40'57"	74.44	47.46	80.30	S-27°11'00"-W
10.	60.00	59°55'53"	54.41	30.53	56.48	S-38°07'44"-E
11.	60.00	32°39'52"	33.74	17.58	34.21	N-16°32'46"-E
12.	60.00	8°43'25"	9.13	4.58	9.14	N-37°14'25"-E
13.	60.00	78°54'22"	76.25	49.38	82.63	N-2°08'55"-E
14.	60.00	22°27'01"	23.36	11.91	23.51	N-48°31'46"-W
15.	60.00	101°21'23"	92.83	73.25	106.14	S-9°30'14"-W
16.	60.00	9°14'13"	9.66	4.85	9.67	S-36°33'21"-E
17.	60.00	32°09'04"	33.23	17.29	33.67	S-15°51'42"-E

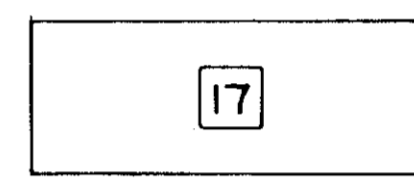

NOTE: A SQUARE AROUND THE SUBLT NUMBER DENOTES THAT THIS IS AN EXISTING SUBLT CONTAINED IN FULLER & NELSON'S SUBDIVISION AS RECORDED IN PV. 2, PG. 18 OF THE LORAIN CO. PLAT RECORD. NOT A PART OF THE RE-SUBDIVISION.

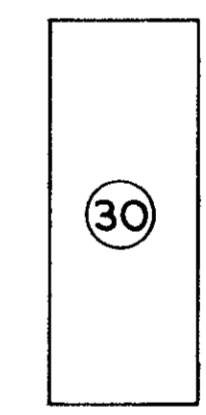

NOTE: A CIRCLE AROUND THE SUBLT NUMBER DENOTES THAT THIS IS AN EXISTING SUBLT CONTAINED IN THE LINDALE ALLOTMENT AS RECORDED IN PV. 6, PG. 42 OF THE LORAIN CO. PLAT RECORD. NOT A PART OF THE RE-SUBDIVISION.

NOTE: THE ALLEY RUNNING NORTH-SOUTH BETWEEN FULLER ST. & STATE ST. WAS VACATED BY ORDINANCE NO. 72-209. THE REMAINING SUBLT ALLEYS WERE VACATED BY ORDINANCE NO. 75-141.

NOTE: THE FOLLOWING SUBLTS CONTAINED IN THE ORIGINAL PLAT OF THE FULLER NELSON SUBDIVISION HAVE BEEN DELETED AND ARE A PART OF THE RE-SUBDIVISION: 1 2 3 4 5 6 7 8 9 12 13 14 20 21 22 23 24 25 27 28 29 30 31 36 37 38 39 40 41 42 43 47 48 49 50 51 52 53 54.

NOTE: THE FOLLOWING SUBLTS CONTAINED IN THE ORIGINAL PLAT OF THE LINDALE ALLOTMENT HAVE BEEN DELETED AND ARE A PART OF THE RE-SUBDIVISION: 1 2 3 6 8 9 10 11 12 13 14 15 16 17 18 19 21 22 23 24 26 27 28 36 37 38 39 40 41 42 47 48 49 50 57 58 59 60 66 67 68 69 70 71 72 73 74 75 76 77 81 82 83 84 85 87 88 89 90 91 92 93 94 96 97 98 99 100 101 102 103 104 105 106 107 108 109 110 111 112 113 114 115 116 117 118 119 120 121 122 123 124 125 126 127 128 129 130.

NOTE: THIS PLAT IS BEING RE-RECORDED TO SHOW DIMENSIONS AND ANGLES PER BOUNDARY SURVEY OF THE FULLER AND NELSON SUBDIVISION ONLY. LOTS SHOWN NOT PART OF THE RESUBDIVISION OF THE SAME HAVE TWO DIMENSIONS SHOWN: THE ORIGINAL PLAT DIMENSION AND THE PRORATED DIMENSION (INDICATED "P.") NECESSARY TO MAKE THE BLOCK CONSISTENT WITH THE TOTAL LENGTH PER SURVEY.

REVISED: JUNE 19, 1978  
REVISED: AUG. 24, 1977