

1995
LORAIN COUNTY OHIO
OHIO NORTH ZONE(3401)
NAD_83

POINT NUMBER: LC090

LATITUDE: 41:29'23.05527" N LONGITUDE: 82:06'46.08811" W

EASTING(FT) 2074580.61 NORTHING(FT) 664432.95 ELEV(FT) 594.30 NAVD_88

EASTING(M) 632333.433 NORTHING(M) 202519.568 ELEV(M) 181.143 NAVD_88

THETA: 0:15'15.730" COMBINATION FACTOR: 0.999937797

DESIGNATION: LC-90 1995 LORAIN CO GPS CONTROL POINT

MONUMENT TYPE: 5/8" dia aluminum rod monument with a 2 1/2" dia stamped aluminum survey cap encased in a PVC pipe with an aluminum access cover. Approx 6" below the surface of the ground.

PRINTED February 26, 1996

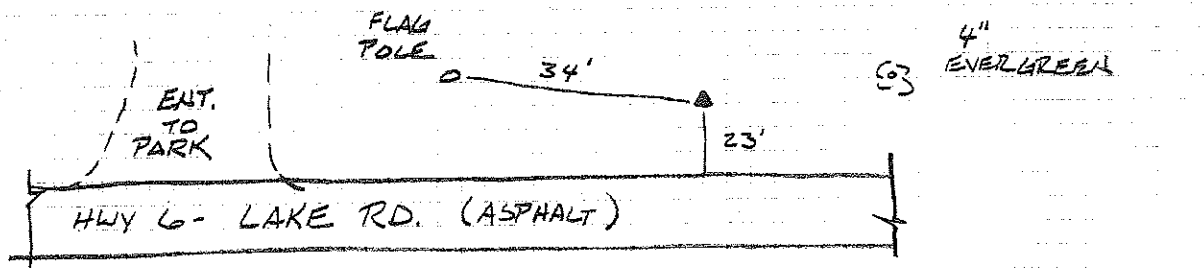

LL 90



SET MONUMENT
100' ± E. OF TREE INTER.
(LAKE BICEEZE)