

MAP OF
CARLISLE TOWNSHIP

4

7

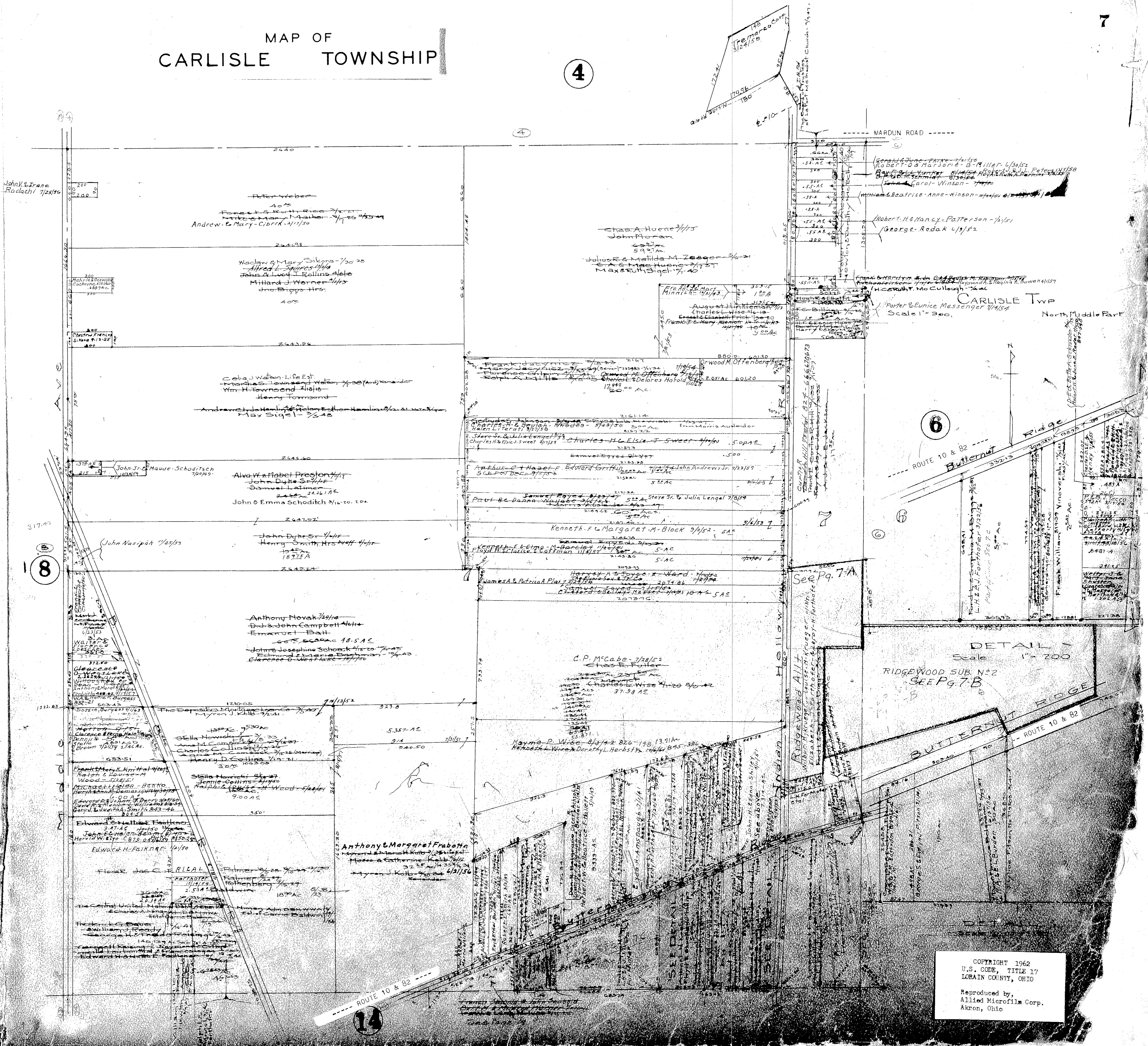

John & Irene Radach 7/25/50

Peter Weber
40 AC
Forest & Ruth Rice 7/21/50
Andrew & Mary Gibrik 7/1/50

Chas. A. Hoene 7/1/50
John Moran
59 AC

Robert O. & Marie B. Miller 4/30/52
George Rodak 4/1/52
George Rodak 4/1/52

Wladyslaw & Mary Sikora 7/30/50
John & Lucy J. Rollins 4/1/50
Mittard J. Warner 4/1/50
dno. Biggs Hrs.
40 AC

John & Matilda M. Zeger 5/6/50
E. A. & Mac Huong 7/1/50
Max & Ruth Sigel 7/1/50

Robert H. & Nancy Patterson 7/1/51
George Rodak 4/1/52

Celia J. Walton Life Est.
Martha Townsend Watson 7/30/50 (And) remainder
Wm. H. Townsend 4/1/50
Henry Townsend

Frank & Mary 7/1/50
August H. H. H. 7/1/50
Charles W. 7/1/50

CARLISLE TWP
Scale 1" = 300'
North Middle Part

Alva W. & Isabel Preston 7/1/50
Samuel Lattimer
John & Emma Schoditch 7/16/50 20 AC

Paul & Be. 7/1/50
Kenneth F. & Margaret M. Block 9/1/52 5 AC

ROUTE 10 & 82
BUTTERNUT RIDGE

John Dyer Sr. 7/1/50
Henry Smith Hrs 7/1/50

James A. & Patricia 7/1/50
C. P. McCabe 7/1/52
Chas. E. Fuller

DETAIL 1
Scale 1" = 200'
RIDGEWOOD SUB. NO. 2
SEE Pg. 7B

Anthony Novak 7/1/50
Dn. & John Campbell 7/1/50
Emanuel Ball
John & Josephine Schoeck 7/1/50
Emanuel & Marie 7/1/50

James A. & Patricia 7/1/50
C. P. McCabe 7/1/52
Chas. E. Fuller

DETAIL 2
Scale 1" = 200'
RIDGEWOOD SUB. NO. 2
SEE Pg. 7B

Stella Nowicki 7/1/50
Anna M. Campbell 7/1/50
Charles Collins 7/1/50
Henry D. Collins 7/1/50

Mayme P. W. 7/1/50
Kenneth W. 7/1/50

DETAIL 3
Scale 1" = 200'
RIDGEWOOD SUB. NO. 2
SEE Pg. 7B

Stella Nowicki 7/1/50
Jennie Collins 7/1/50
Ralph L. 7/1/50

Anthony & Margaret Frabotta
Moses & Catherine Kell 7/1/50
Myron J. Kell 7/1/50

DETAIL 4
Scale 1" = 200'
RIDGEWOOD SUB. NO. 2
SEE Pg. 7B

Edward H. Frick 7/1/50
Howard J. C. 7/1/50
The Central United National Bank 7/1/50

Anthony & Margaret Frabotta
Moses & Catherine Kell 7/1/50
Myron J. Kell 7/1/50

DETAIL 5
Scale 1" = 200'
RIDGEWOOD SUB. NO. 2
SEE Pg. 7B

Edward H. Frick 7/1/50
Howard J. C. 7/1/50
The Central United National Bank 7/1/50

Anthony & Margaret Frabotta
Moses & Catherine Kell 7/1/50
Myron J. Kell 7/1/50

DETAIL 6
Scale 1" = 200'
RIDGEWOOD SUB. NO. 2
SEE Pg. 7B

COPYRIGHT 1962
U.S. CODE, TITLE 17
LORAIN COUNTY, OHIO
Reproduced by,
Allied Microfilm Corp.
Akron, Ohio

14

42