

RIDGEVILLE TWP.

East Middle Part. Scale - 1"=400'

10

Easement to State Vol 277-216

COPYRIGHT 1962 U.S. CODE, TITLE 17 LOHAIN COUNTY, OHIO

Reproduced by, Allied Microfilm Corp. Akron, Ohio

RIDGEVILLE TOWNSHIP

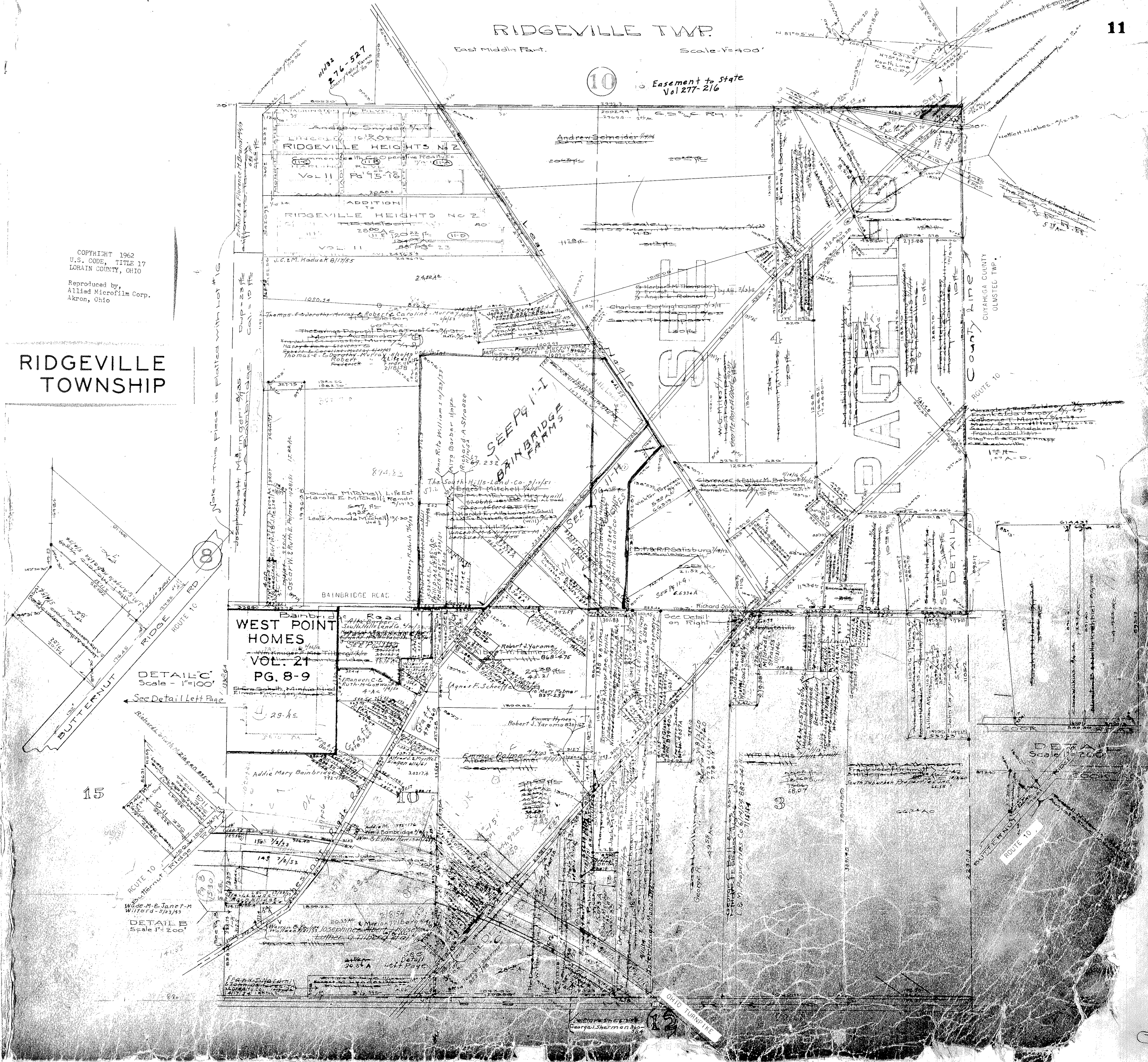

State - this piece is plotted with lot #16

SEE PG 1-1 BAINBRIDGE FARMS

SEE PG 1-1

SEE PG 1-1

SEE PG 1-1

DETAIL C Scale - 1"=100' See Detail Left Page

DETAIL B Scale 1"=200'

DETAIL Scale 1"=200'

15

710

88