

The Border Cities Co's Shore Sub & Buckeye Country Club.
Vol. 11 Pg 21 & 22
Lots in blank - The Border Cities Co.
The B of L E Coop Nat'l Bank - West
Engineers National Bank of Cleveland 7/15/59
Cleveland Trust Bank 7/15/59
Engineers National Bank of Clev. - 7/15/59

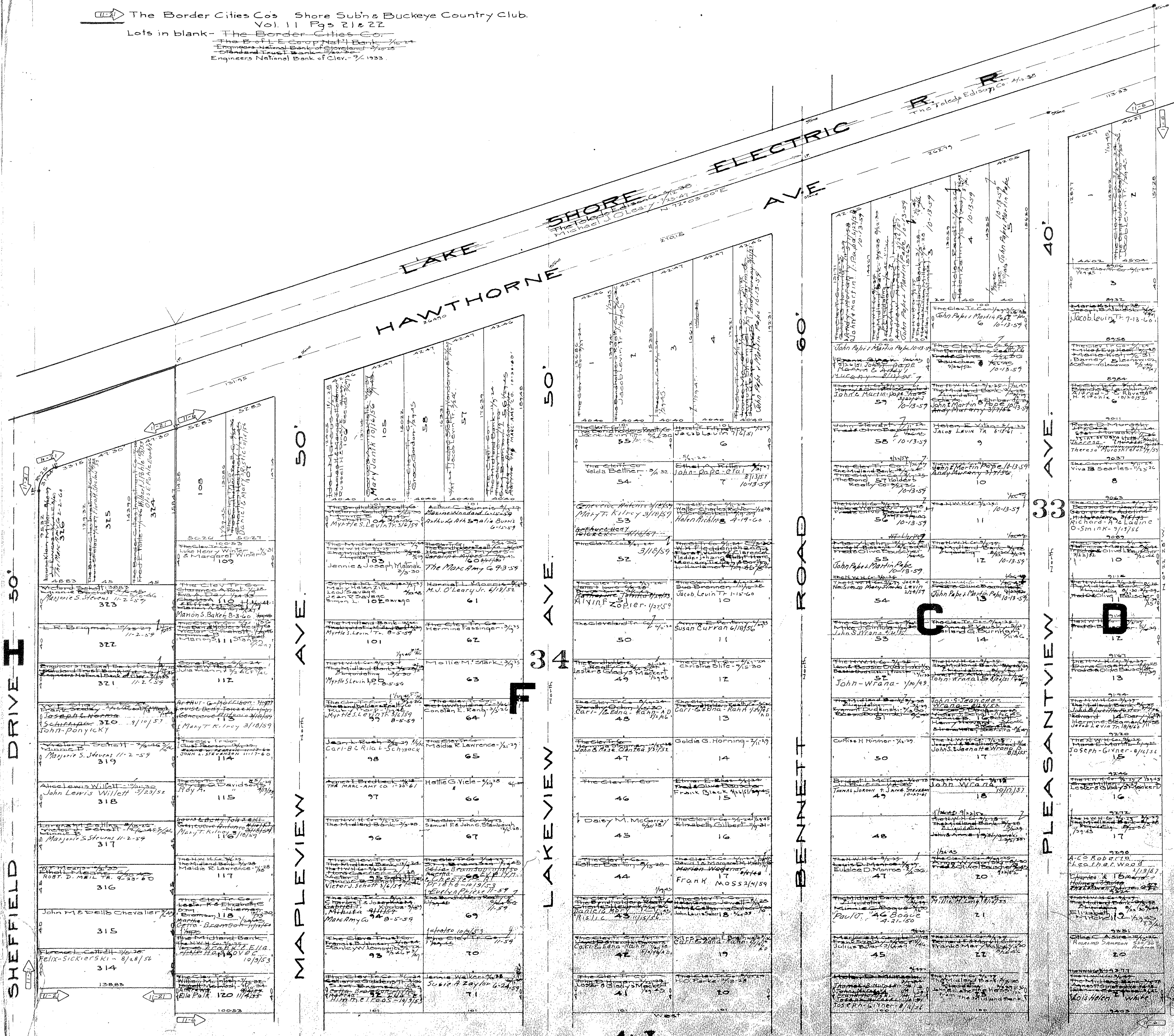

COPYRIGHT 1962
U.S. CODE, TITLE 17
LORAIN COUNTY, OHIO
Reprinted by,
Allied Microfilm Corp.
Akron, Ohio

SHEFFIELD LAKE
VILLAGE

4-J