

APPROVED FOR DRAINAGE
A.E. Peterson
 LOZAIN COUNTY ENGINEER

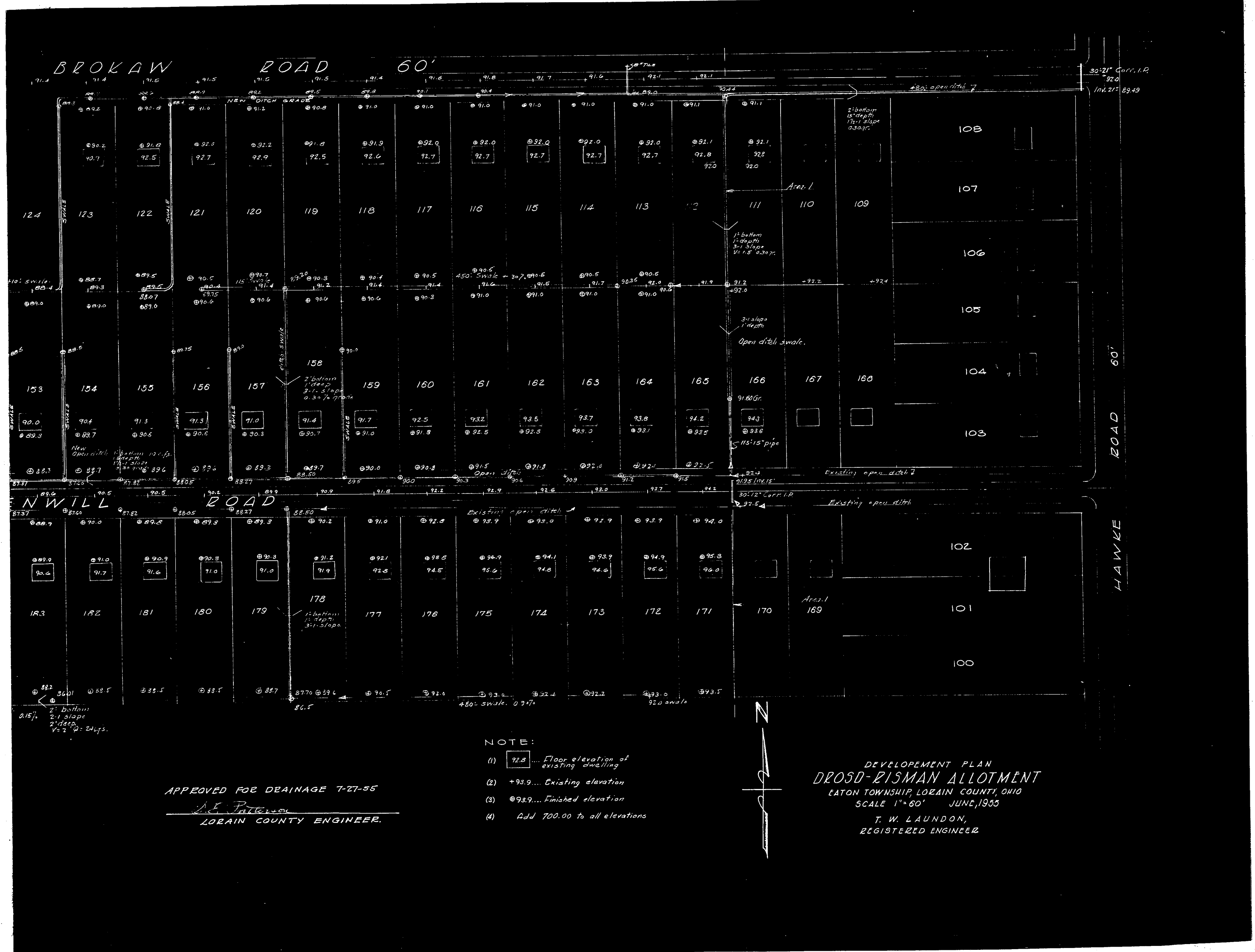

APPROVED FOR DRAINAGE 7-27-55
A.E. Peterson
 LOZAIN COUNTY ENGINEER

- NOTE:
- (1) 92.8 - Proposed elevation of existing drainage
 - (2) 92.9 - Existing elevation
 - (3) 92.9... - Finished elevation
 - (4) Add 700.00 to all elevations

DEVELOPMENT PLAN
 DROWD-PISMAN ALLOTMENT
 LATON TOWNSHIP LOZAIN COUNTY, OHIO
 SCALE 1" = 60'
 JUNE, 1955
 T. W. LAUNDON,
 REGISTERED ENGINEER

July 8, 1955.
 This is to certify that this Photostat Copy of the
 drainage Plat of the Drowd-Pisman Allotment, Eaton
 Twp. was made from the Original.
 This Plat relates to the Drowd-Pisman Allotment
 found recorded in Lorain County Record of Plats,
 Vol. 16, page 26.
Leota B. Mitchell, Lorain County Recorder

Received for Record JUL 8 - 1955
 at 8:33 A.M. Recorded 8:33 A.M.
 in Record, Vol. 18 Page 16
Leota B. Mitchell
 Lorain County Recorder

Recording Fee \$ 15 00