

# THE COMMONS OF FIELDSTONE LAKES PH. 12

CREATING SUBLOTS 29 And 30, BEING A RE-SUBDIVISION OF BLOCK "J" OF THE COMMONS OF FIELDSTONE LAKES TOWN HOMES PH.11 AS SHOWN BY PLAT RECORDED IN VOLUME 100, PAGE 05 OF PLATS, BEING PART OF ORIGINAL EATON TOWNSHIP LOT No.90 AND LOT No.91, NOW IN THE CITY OF ELYRIA, LORAIN COUNTY, OHIO

Town Homes

BLOCK 'C' THE VILLAGE OF FIELDSTONE LAKES PHASE No.1

N.01°00'01"E. 574.06' RECORD & USED

**ACCEPTANCE:**

FIELDSTONE LAKES LTD., BY ITS PRESIDENT THOMAS G. SIMON OWNER OF THE HEREON PLATTED LANDS DOES HEREBY ACKNOWLEDGE THAT THIS PLAT WAS MADE PER ITS REQUEST AND DOES HEREBY ACCEPT THIS PLAT AS ITS FREE ACT AND DEED.

FIELDSTONE LAKES, LTD.

*Thomas G. Simon*  
THOMAS G. SIMON, PRESIDENT

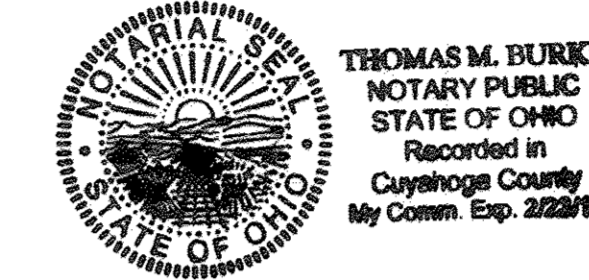

**NOTARY:**

COUNTY OF Cuyahoga S.S.  
STATE OF OHIO

BEFORE ME, A NOTARY PUBLIC IN AND FOR SAID COUNTY AND STATE, PERSONALLY APPEARED THE ABOVE NAMED THOMAS G. SIMON, PRESIDENT OF FIELDSTONE LAKES, LTD., A NOTARY PUBLIC IN AND FOR SAID COUNTY AND STATE, WHO ACKNOWLEDGE THE SIGNING OF THE FOREGOING INSTRUMENT TO BE HIS FREE ACT AND DEED IN WITNESS WHEREOF, I HAVE SET MY HAND AND OFFICIAL SEAL AT Elyria, OHIO, THIS 12 DAY OF December, 2014.

*Thomas M. Burick* MY COMMISSION EXPIRES: 2/23/15  
NOTARY PUBLIC

**LAND DISTRIBUTION**

SINGLE FAMILY LOTS = 0.2841 ACRE  
BLOCK "K" = 7.5057 ACRES  
TOTAL THIS PHASE = 7.7898 ACRES

**CURVE DATA**

- |                                                                       |                                                                       |                                                                     |                                                                       |                                                                       |
|-----------------------------------------------------------------------|-----------------------------------------------------------------------|---------------------------------------------------------------------|-----------------------------------------------------------------------|-----------------------------------------------------------------------|
| ① R=250.00'<br>A=120.16'<br>C=119.01'<br>N.77°04'27"E.<br>Δ=27°32'18" | ② R=250.00'<br>A=118.37'<br>C=117.27'<br>S.76°52'09"W.<br>Δ=27°07'42" | ③ R=250.00'<br>A=49.56'<br>C=49.48'<br>S.84°45'14"W.<br>Δ=11°21'33" | ④ R=280.00'<br>A=132.57'<br>C=131.34'<br>S.76°52'09"W.<br>Δ=27°07'42" | ⑤ R=220.00'<br>A=105.74'<br>C=104.73'<br>S.77°04'27"W.<br>Δ=27°32'18" |
| ⑥ R=20.00'<br>A=31.42'<br>C=28.28'<br>N.44°09'24"W.<br>Δ=90°00'00"    | ⑦ R=100.00'<br>A=30.63'<br>C=30.51'<br>S.07°55'54"E.<br>Δ=17°33'01"   | ⑧ R=100.00'<br>A=31.04'<br>C=30.91'<br>S.07°48'56"E.<br>Δ=17°46'58" | ⑨ R=35.00'<br>A=54.88'<br>C=49.43'<br>N.45°59'55"E.<br>Δ=89°50'43"    |                                                                       |

**SHORT LINES**

L1 = S.00°50'36"W. 29.93'

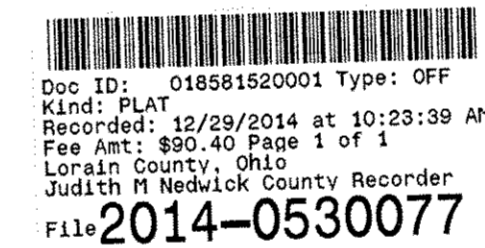

CARDINAL HOPE EXAM CO.  
708 PARK AVE  
ELYRIA, OH 44035  
Plat Vol.100  
Pg. 57

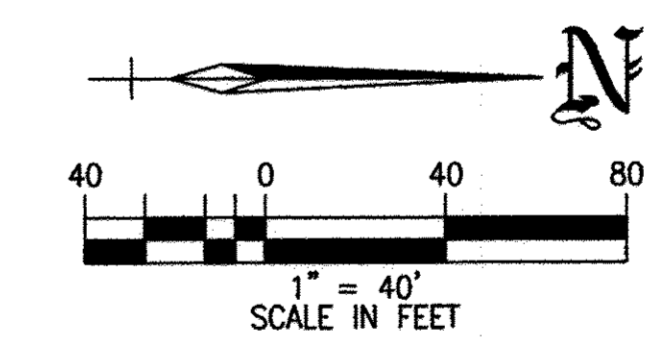
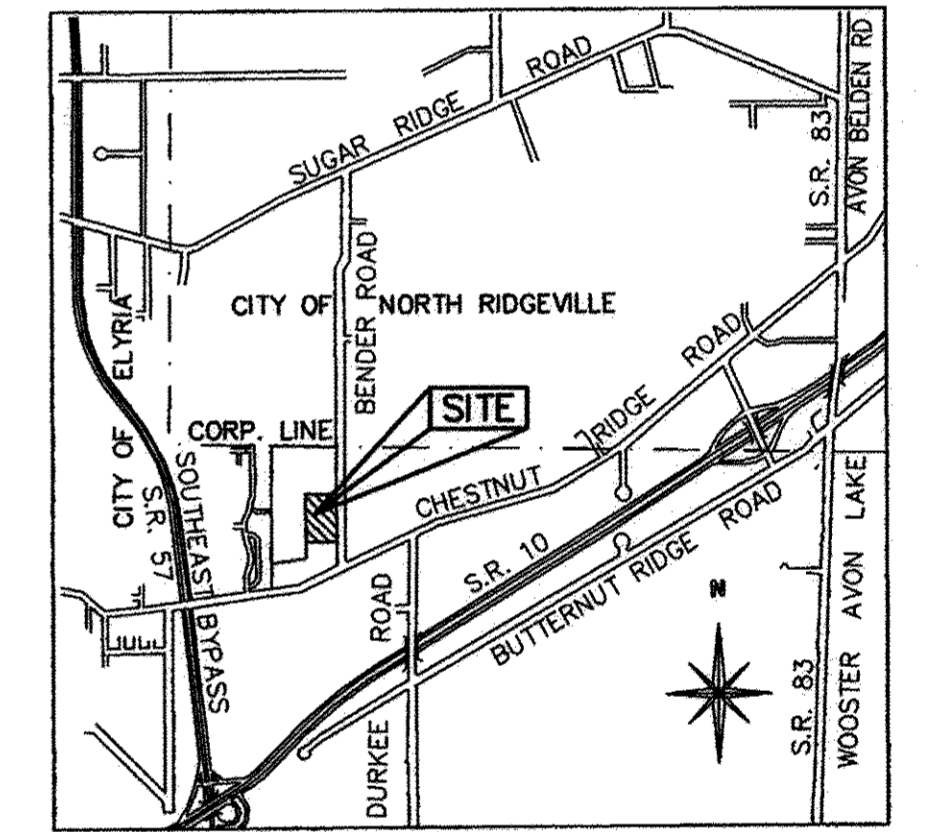

**LEGEND:**

- ◆ IRON PIN MONUMENT FOUND AND USED
- 5/8 INCH DIAMETER IRON PIN FOUND

**NOTE:**

ALL SUBLOTS SHOWN HEREON SHALL HAVE THE FOLLOWING BEARINGS:

NORTH & SOUTH DIRECTION = N.01°04'33"E.  
EAST & WEST DIRECTION = N.88°55'27"W.

NOTE: THE SUBLOTS SHOWN HEREON ARE SUBJECT TO THE "DECLARATION OF COVENANTS AND RESTRICTIONS" FILED FOR RECORD IN INSTRUMENT No. 20060144904 AND INSTRUMENT No.20060144906 OF THE LORAIN COUNTY RECORDS.

PREPARED BY  
**The Western Reserve Surveying Co.**  
4705 STATE ROAD, CLEVELAND, OHIO 44109  
(216) 741-0110 / (216)741-3243 / FAX (216)741-3926

*Richard F. Hantel*  
RICHARD F. HANTEL  
REG. No. S-5129

**TRANSFERRED**  
IN COMPLIANCE WITH SEC. 319-202  
OHIO REV. CODE  
DEC 29 2014

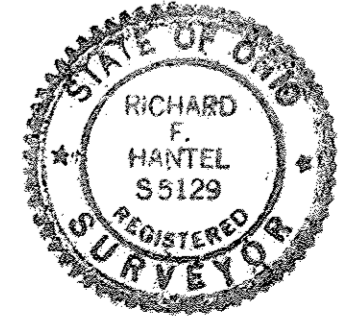

J. CRAIG SNODGRASS, CPA, CGFM  
LORAIN COUNTY AUDITOR

PPN 11--00--090--000--030  
EDWARD KRECC & ANTHONY KRECC  
VOL. 852, PG. 531

C:\Land Projects 2008\A4762\DWG\PLATS\A4762\_SUBD\_PLAT\_12.dwg (PLAT)