

# THE COMMONS OF FIELDSTONE LAKES TOWN HOMES PH. 11

BEING A RE-SUBDIVISION OF BLOCK "I" OF THE COMMONS OF FIELDSTONE LAKES TOWN HOMES PH. 10 AS SHOWN BY THE PLAT RECORDED IN VOLUME 99, PAGE 04 OF PLATS, BEING PART OF ORIGINAL EATON TOWNSHIP LOT NO. 90 & LOT NO. 91, NOW IN THE CITY OF ELYRIA, LORAIN COUNTY, OHIO

**ACCEPTANCE:**

FIELDSTONE LAKES, LTD. by its president Thomas G. Simon, owner of the hereon plated lands, does hereby acknowledge that this plat was made per its request and does hereby accept this plat as its free act and deed.

FIELDSTONE LAKES, LTD.

*Thomas G. Simon*  
Thomas G. Simon, President

State of Ohio, County of Cuyahoga: SS  
Before me, a Notary Public in and for said county and state, did personally appear the above-signed Thomas G. Simon, who did acknowledge the making of the foregoing instrument, in witness whereof I have hereunto set my hand and official seal at Berea, Ohio, this 17 day of March, 2014.

*Thomas M. Burke* 2/23/16  
Notary Public my commission expires

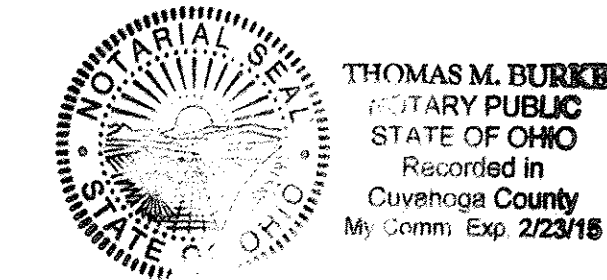

**LAND DISTRIBUTION:**

SINGLE FAMILY LOTS = 0.2030 ACRE  
BLOCK "J" = 7.5868 ACRES  
TOTAL THIS PHASE = 7.7898 ACRES

**CURVE DATA:**

C1 R = 250.00' D = 27° 32' 18" L = 120.16' T = 61.26' C = 119.01' N 77° 04' 27" E	C2 R = 250.00' D = 27° 07' 42" L = 118.37' T = 60.32' C = 117.27' S 76° 52' 09" W	C3 R = 250.00' D = 11° 21' 33" L = 49.56' T = 24.86' C = 49.48' S 84° 45' 14" W	C4 R = 280.00' D = 27° 07' 42" L = 132.57' T = 67.55' C = 131.34' S 76° 52' 09" W
---	---	---	---

C5 R = 220.00' D = 27° 32' 18" L = 105.74' T = 53.91' C = 104.73' S 77° 04' 27" W	C6 R = 20.00' D = 90° 00' 00" L = 31.42' T = 20.00' C = 28.28' N 44° 09' 24" W	C7 R = 100.00' D = 17° 33' 01" L = 30.63' T = 15.44' C = 30.51' S 07° 55' 54" E	C8 R = 100.00' D = 17° 46' 58" L = 31.04' T = 15.64' C = 30.91' S 07° 48' 56" E
---	--	---	---

**SHORT LINES:**

C9 R = 35.00' D = 89° 50' 43" L = 54.88' T = 34.91' C = 49.43' N 45° 59' 55" E	L1 = S 00° 50' 36" W 29.93' L2 = S 43° 55' 27" E 2.83' L3 = S 01° 04' 33" W 4.67' L4 = S 46° 04' 33" W 2.83' L5 = S 01° 04' 33" W 1.33'
--	---

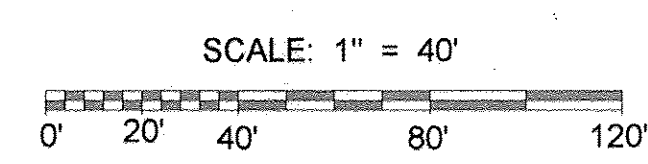
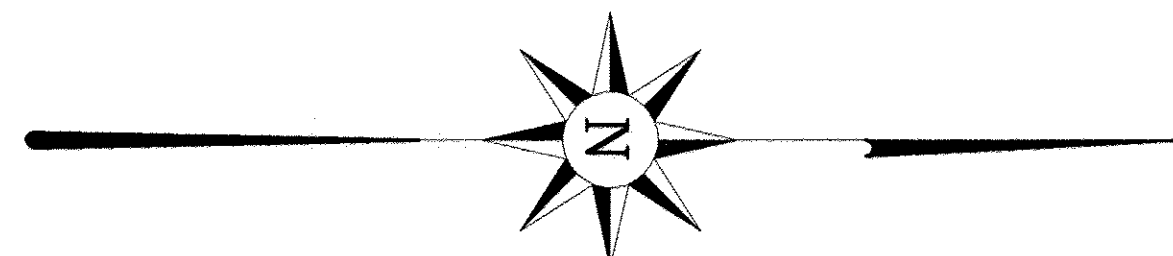
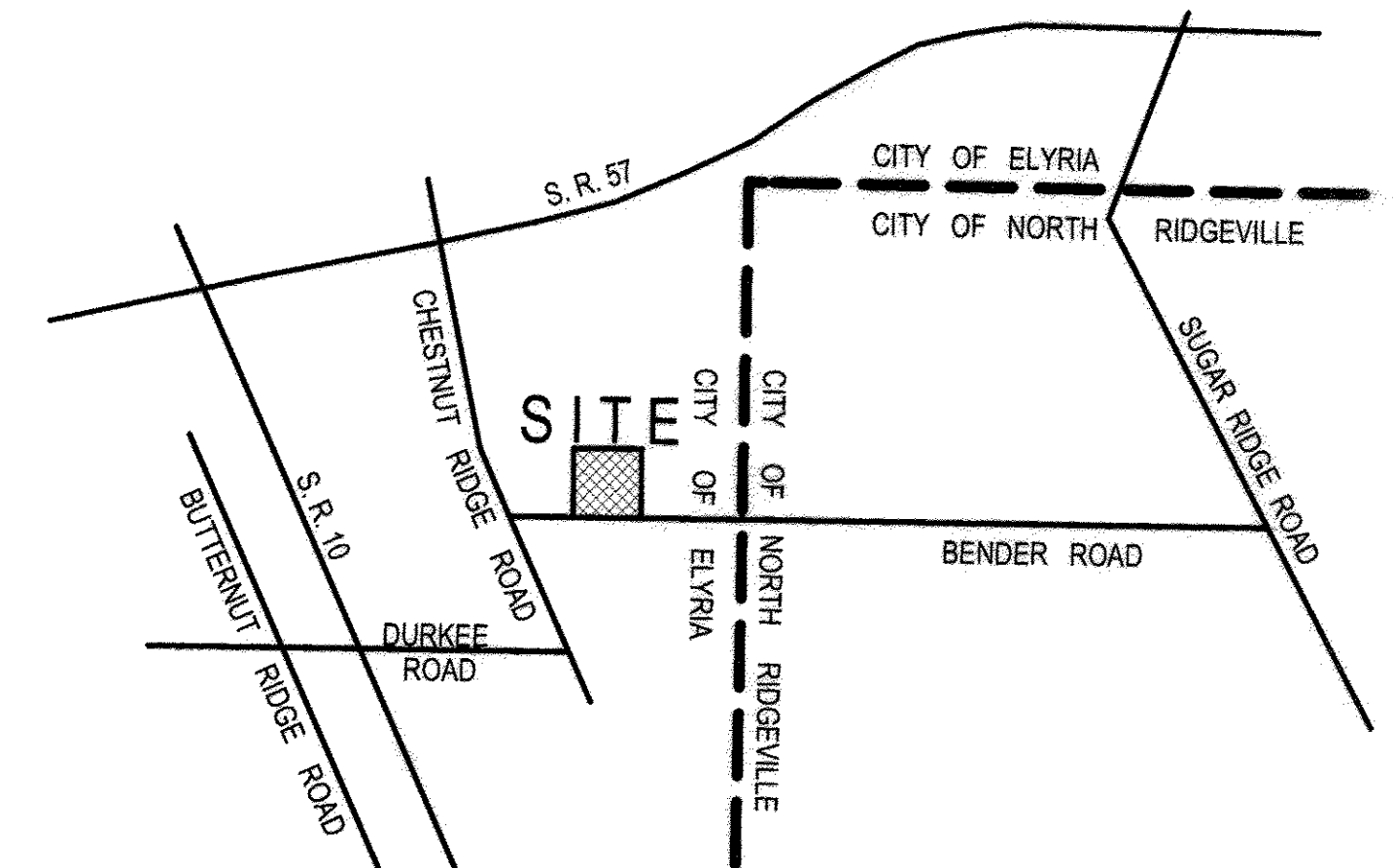

- LEGEND:**
- - iron pin monument found & used
  - - 5/8-inch diameter iron pin found

**NOTE:**  
ALL SUBLOTS SHOWN HEREON SHALL HAVE THE FOLLOWING BEARINGS:

north & south direction = N 01° 04' 33" E  
east & west direction = N 88° 55' 27" W

**NOTE:** THE SUBLOTS SHOWN HEREON ARE SUBJECT TO THE "DECLARATION OF COVENANTS AND RESTRICTIONS" filed for record in Instrument No. 20060144904 and Instrument No. 20060144906 of the LORAIN COUNTY RECORDS.

PREPARED BY:  
**ZWICK ASSOCIATES, INC.**  
Engineers - Surveyors - Planners  
8750 Stearns Road, Olmsted Township, Ohio 44138  
Tel: (440) 235 - 2729 Fax: (440) 235 - 0604  
E-mail: ZWICK@eng.ohiocoxmail.com

I declare the boundary of this plat to be a true representation of BLOCK "B" of FIELDSTONE LAKES SUBDIVISION No. 1 (Plat Volume 88, Pages 5-7) and a subdivision thereof. Distances are given in feet and decimal parts thereof. North datum used is the bearing of record for the centerline of Bender Road as shown on said plat. Property corners were found or set as indicated. All iron pins set are 5/8-inch diameter, 30 inches long, with "ZWICK" cap.

*Peter D. Zwick*  
Peter D. Zwick, P. S. No. 7429 March 12, 2014



Doc ID: 018144790001 Type: OFF  
Kind: PLAT  
Recorded: 03/17/2014 at 08:23:52 AM  
Fee Amt: \$90.40 Page 1 of 1  
Lorain County, Ohio  
Judith H. Newkirk County Recorder  
File: 2014-0508375

**TRANSFERRED**  
IN COMPLIANCE WITH SEC. 319-202  
OHIO REV. CODE  
JUN 17 2014  
J. CRAIG SNOODGRASS, CPA, CGFM  
LORAIN COUNTY AUDITOR

CARDINAL HOPE / LIZ  
708 PARK AVE  
ELYRIA, OH 44035  
Plat Vol. 100  
Pg. 5

BLOCK "C" of FIELDSTONE LAKES SUBDIVISION No. 1

BLOCK "A" of FIELDSTONE LAKES SUBDIVISION No. 1

7.5868 ACRES

CARRINGTON COURT (private roadway)

BRECKENRIDGE OVAL (private roadway)

BENDER ROAD 50'

BRECKENRIDGE OVAL (private roadway)

FIELDSTONE DRIVE 60'

O. L. 91  
O. L. 90

O. L. 91  
O. L. 90

Edward Krecic & Anthony Krecic DEED Vol. 852, Pg. 631 PPN 11-00-090-000-030