

Daniels And Braun's Addition.

TO THE VILLAGE OF LORAIN O.

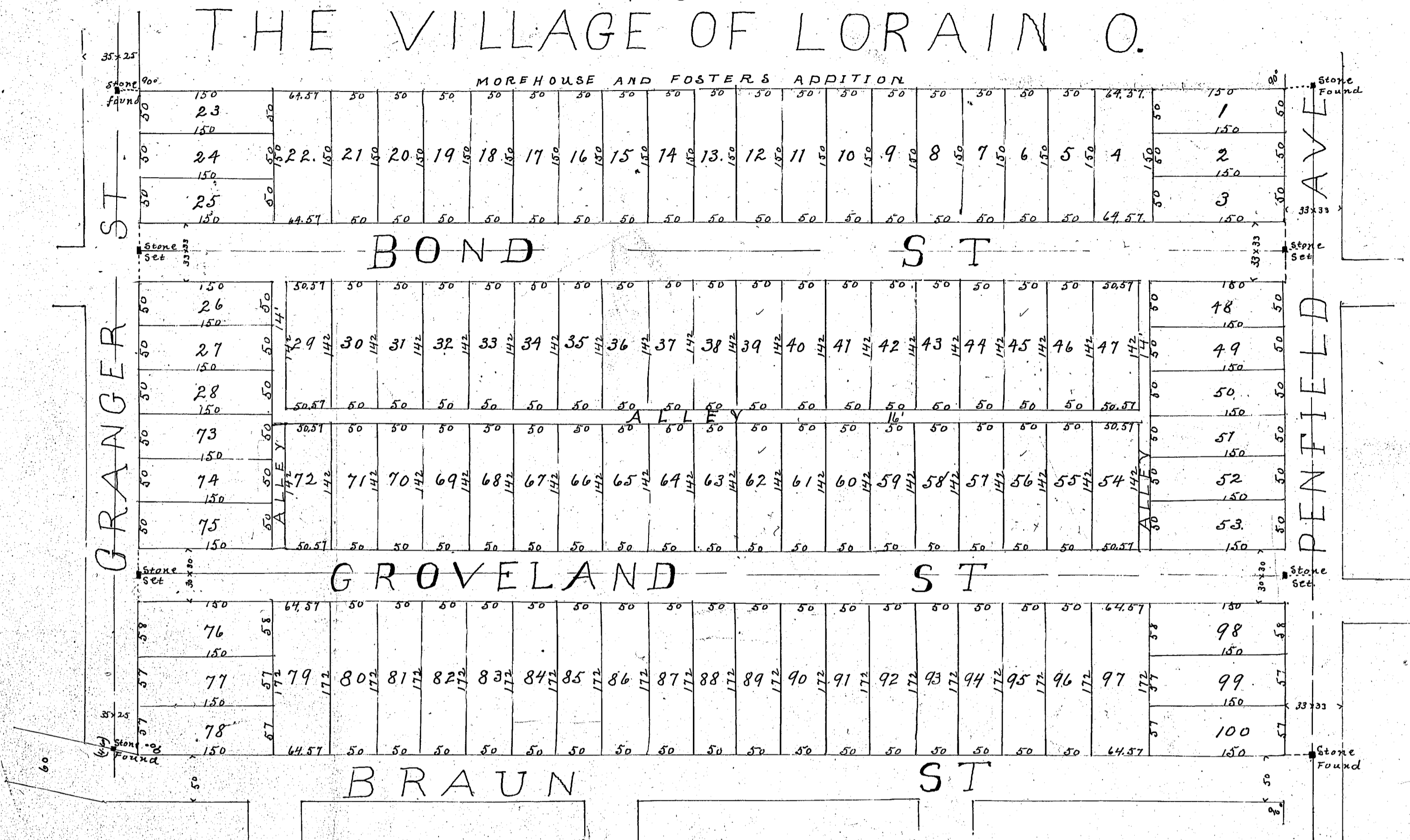

This Addition of 22 ⁹⁶/₁₀₀ acres is situated in Original Lot No. 3, Tract No. 1, Black River Township, now in the Village of Lorain, and is bounded on the North by Morehouse and Foster's Addition, on the East by Penfield Avenue on the South by Braun Street and on the West by Granger Street. Bond Street and Groveland Street are continuations of said streets in Vincent's Dub Division and together with the Alleys and the East 25 ft of Granger Street as shown on the above plat are to be hereby dedicated to public use. Distances are given in feet and decimals thereof. Stone monuments were found or set at all points so indicated on the plat. All of which I hereby certify to be correct.
 Lorain O. Aug 5. 1895. C. L. Loofbourrow Surveyor.
 Scale 100 FT = 1 Inch.

Measurements and courses are consistent, and sufficient number of stone monuments placed.
 Lorain O. Aug 19. L. A. Faiver.
 Received Nov. 19th 1895 at 9³⁰ A.M.

I, Ed. Killmore, the owner of the land contained in this Plat, do hereby acknowledge the accompanying plat and all descriptive notes thereon. In testimony whereof I hereunto set my hand and seal this 5th day of August A.D. 1895.
 Ed. Killmore (L.S.)
 of L. N. Snyder - Byron A. Killmore
 State of Ohio } ss Be it remembered that on the 5th day of August Lorain County A.D. 1895, personally appeared before me the undersigned authority in and for said County, the above named Ed. Killmore who did acknowledge the signing and sealing of the foregoing plat to be his free act and deed. In testimony whereof I hereunto set my hand and official seal this 5th day of August A.D. 1895. L. N. Snyder, Notary Public (Seal)

This is to certify that this plat was by ordinance of the Council of the Village of Lorain, passed Sept. 16, 1895, duly accepted by said Council and the same is here by Approved of and certified to the Recorder of Lorain County for record, by me.
 H. J. Cahoon Recorder.
 Recorded Nov. 29th 1895.

- See Plat Record Vol. 5 page 23 - for corrected Plat -