

# Map of I.D. Lawler Trustee's

*Gregg*

*Estate*

Old Lot 3

Old Lot 2

N. 0° 24' W.  
Old line between lots 2 & 3.

ERIE AVENUE.

GREGG

AVENUE

CAWNA

CLIFF ST.

AVE

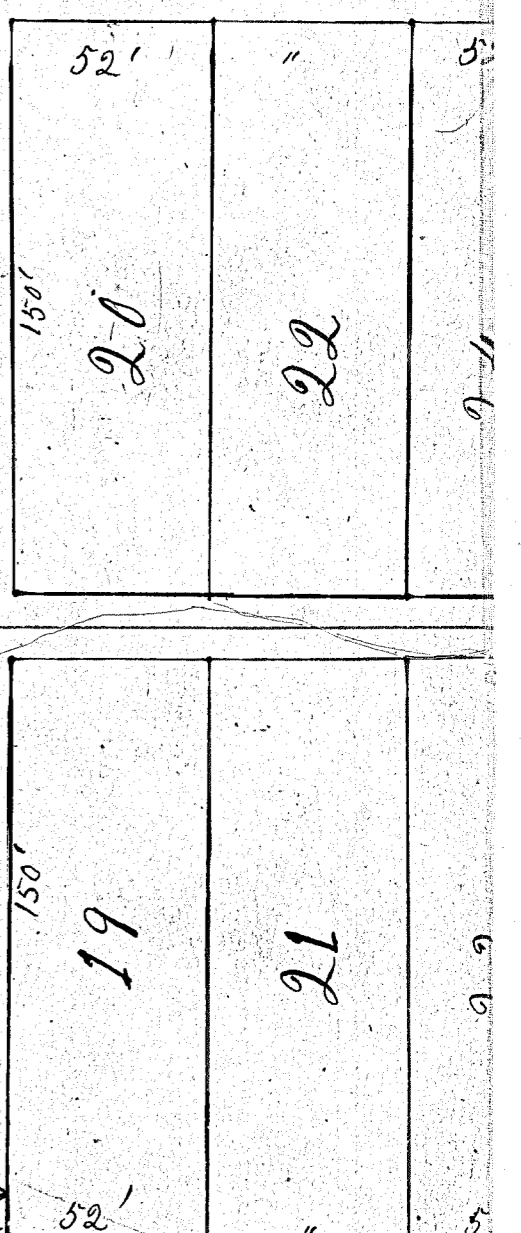
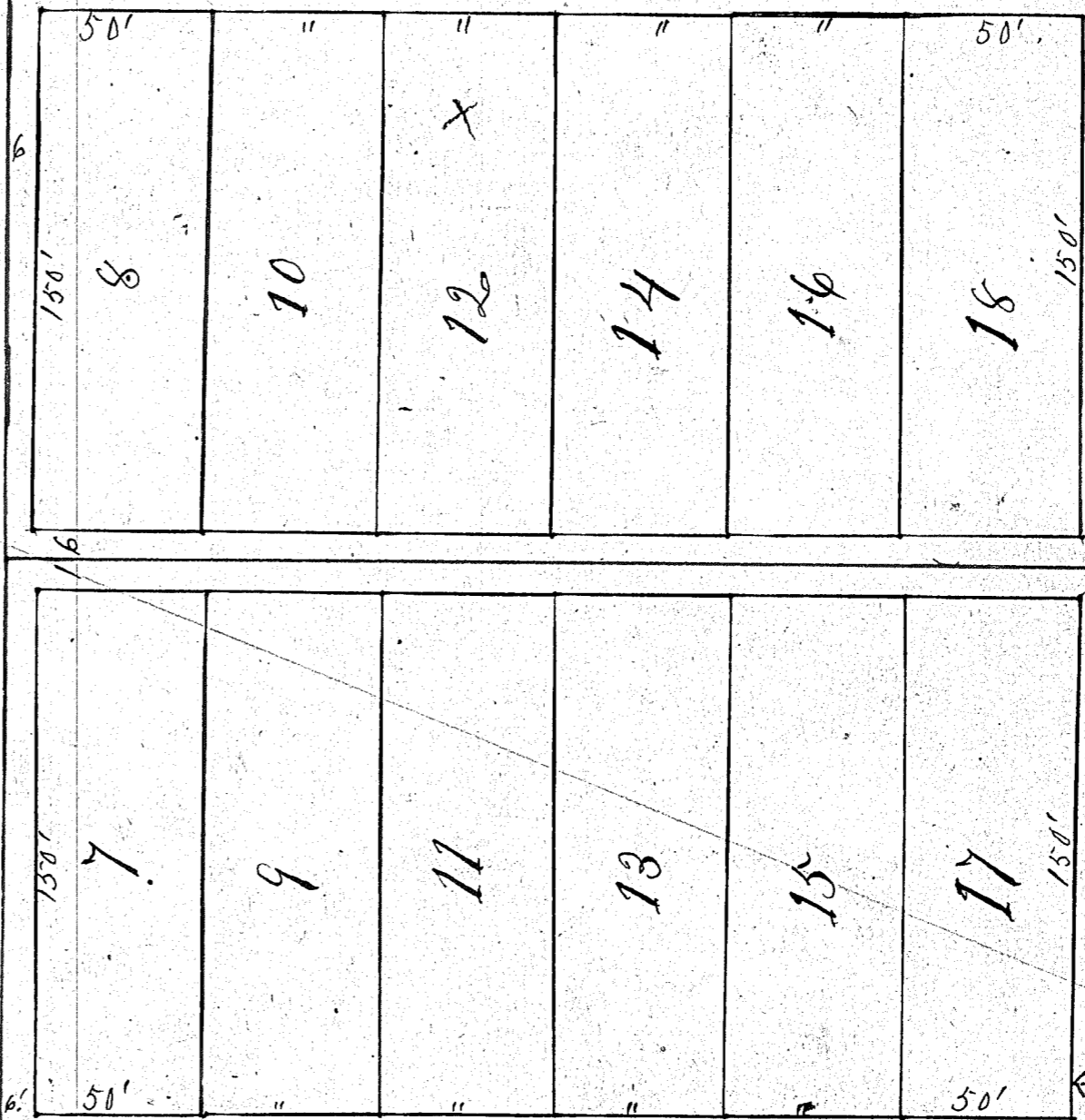
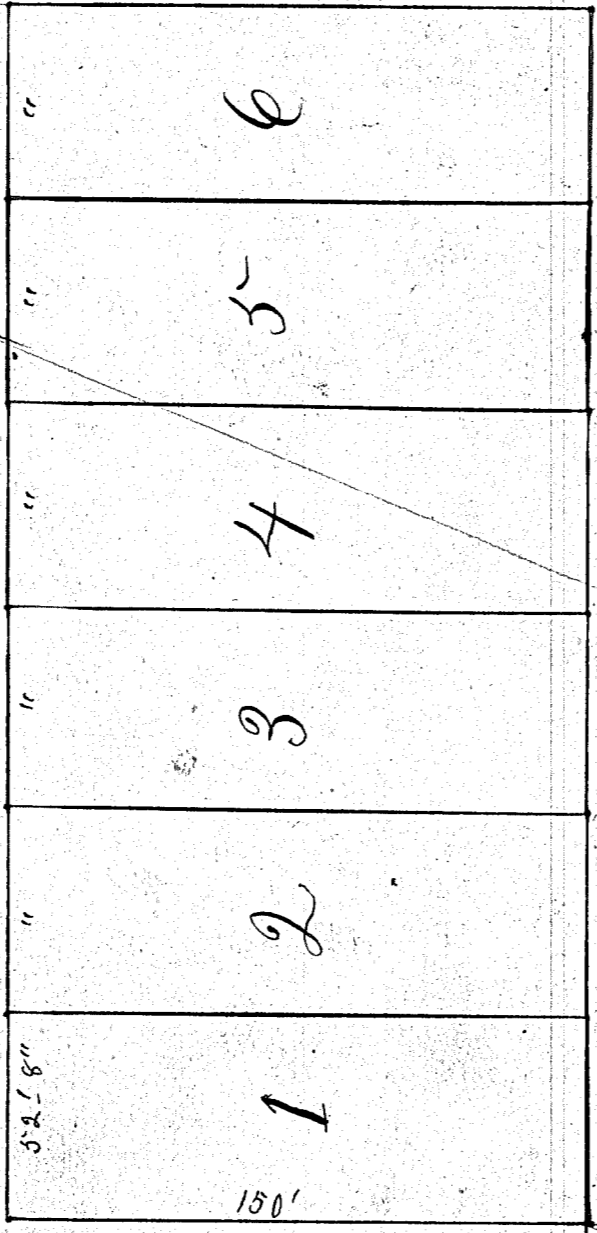
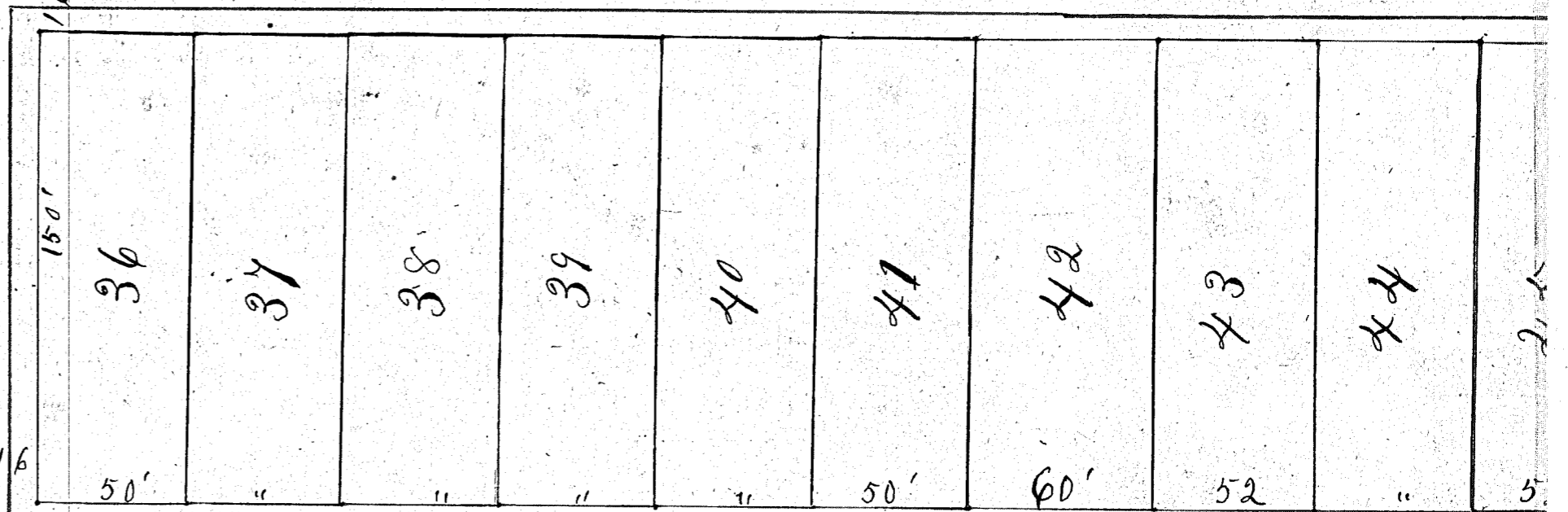
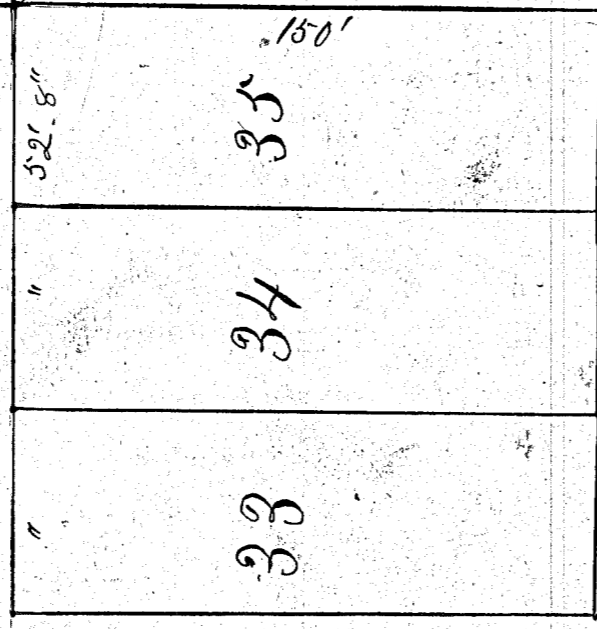

66' FEET

*Thomas Lawn*

60' FEET

